

ASSESSORS: 18 - 2 - 4

REFERENCES:

DEED - BK. 2836 PG. 494

PLAN - UNRECORDED PLAN BY OTTE & DWYER, INC.

DATED: FEBRUARY 6, 1995

VERTICAL DATUM: N.A.V.D. 1988

FEMA: ZONE A - NO FLOOD ELEVATION
MAP NO. 25009C0233F (7/3/2012)
SPILLWAY ELEV. AT SOUTH-WEST
END OF STILES POND = 132.4'

LEGEND & SYMBOLS

| | |
|-------|------------------|
| ELEV. | ELEVATION |
| INV. | INVERT |
| | RETAINING WALL |
| | UTILITY POLE |
| | CHAIN LINK FENCE |
| TBR | TO BE REMOVED |
| CONC. | CONCRETE |
| TEMP. | TEMPORARY |

STILES POND
 WATER ELEV. = 133.8' (12/7/16)
 ELEV. OF SPILLWAY AT SOUTH-WEST
 END OF POND = 132.4'
 ELEV. TOP OF CONCRETE DAM AT
 SOUTH-WEST END OF POND = 136.2'
 (SINCE NO FEMA FLOOD ELEV. HAS
 BEEN ESTABLISHED, 136.2' IS BEING
 USED AS THE FLOOD ELEVATION)

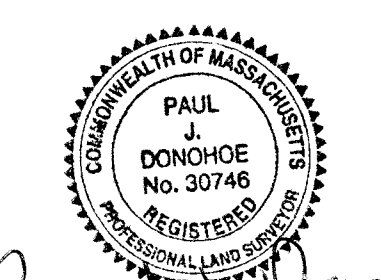
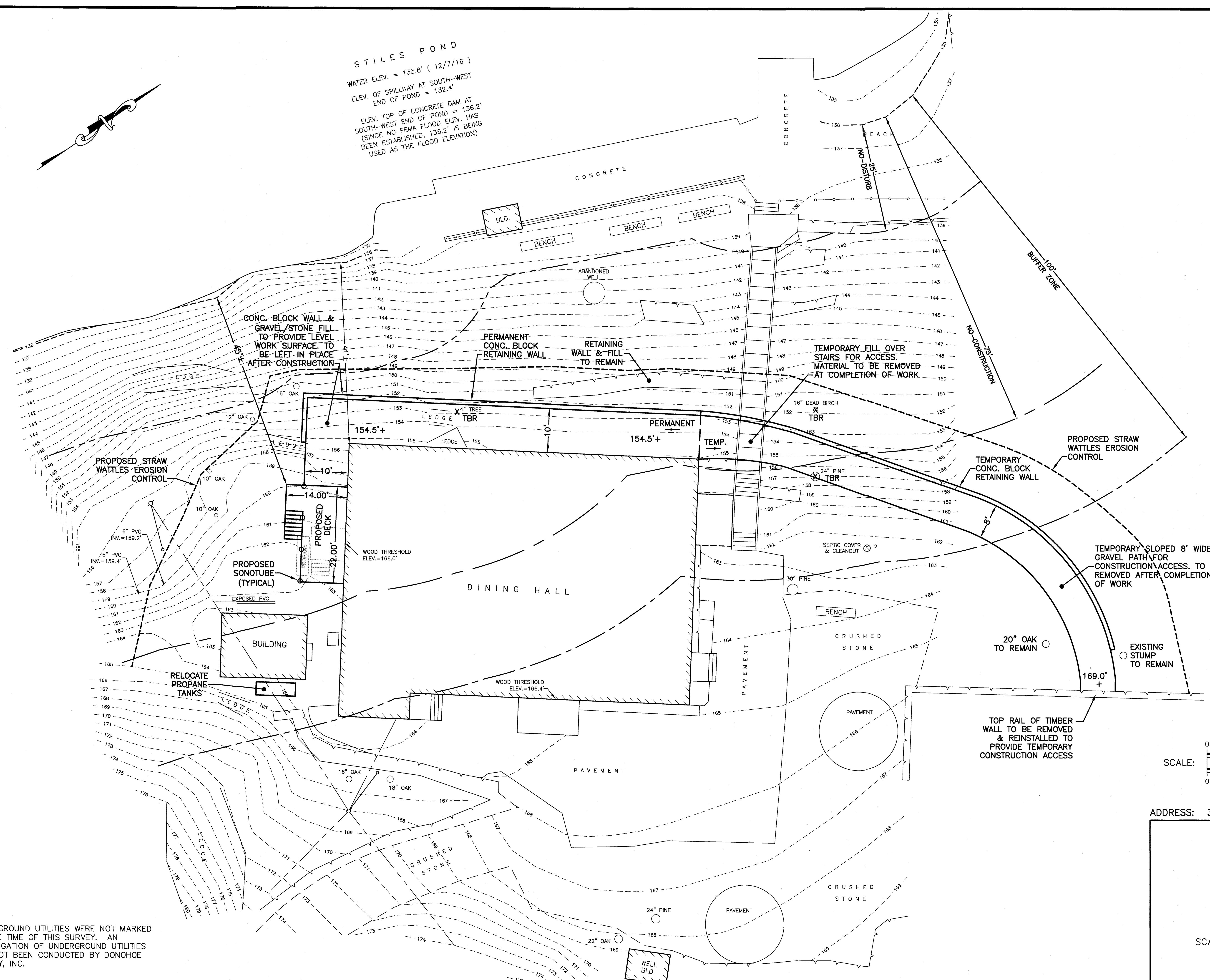

Paul J. Donohoe
 7/17/18

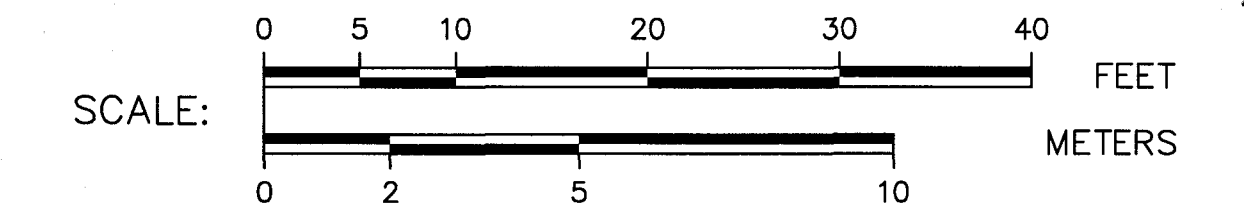

ADDRESS: 372 IPSWICH ROAD

SITE PLAN
 IN
BOXFORD, MA

PROPERTY OF
CAMP ROTARY, INC.

REV. 7/17/18
 SCALE: 1" = 10' DECEMBER 16, 2016

DONOHUE SURVEY, INC.
 363 BOSTON ST. TOPSFIELD, MA
 (978) 887-6161

PROJ. 3306

NOTE:
 • UNDERGROUND UTILITIES WERE NOT MARKED
 AT THE TIME OF THIS SURVEY. AN
 INVESTIGATION OF UNDERGROUND UTILITIES
 HAS NOT BEEN CONDUCTED BY DONOHUE
 SURVEY, INC.