

Massachusetts Department of Environmental Protection  
Bureau of Resource Protection - Wetlands

**WPA Form 3 – Notice of Intent**

Massachusetts Wetlands Protection Act M.G.L. c. 131, §40

Provided by MassDEP:  
MassDEP File Number  
Document Transaction Number  
Boxford  
City/Town

**Important:**  
When filling out forms on the computer, use only the tab key to move your cursor - do not use the return key.

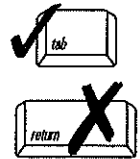

**Note:**  
Before completing this form consult your local Conservation Commission regarding any municipal bylaw or ordinance.

**A. General Information**

1. Project Location (**Note:** electronic filers will click on button to locate project site):

Between Herrick Road and Stiles Pond Road  
a. Street Address  
Boxford  
b. City/Town  
01921  
c. Zip Code  
Latitude and Longitude:  
42.686710  
d. Latitude  
-71.029774  
e. Longitude  
18-2-11  
f. Assessors Map/Plat Number  
g. Parcel /Lot Number

2. Applicant:

Alan  
a. First Name  
Benson  
b. Last Name  
Town of Boxford  
c. Organization  
Town Hall - 7A Spofford Road  
d. Street Address  
Boxford  
e. City/Town  
MA  
f. State  
01921  
g. Zip Code  
9788876000  
h. Phone Number  
9788875361  
i. Fax Number  
abenson@town.boxford.ma.us  
j. Email Address

3. Property owner (required if different from applicant):  Check if more than one owner

a. First Name  
b. Last Name  
c. Organization  
d. Street Address  
e. City/Town  
f. State  
g. Zip Code  
h. Phone Number  
i. Fax Number  
j. Email address

4. Representative (if any):

Richard  
a. First Name  
Tomczyk  
b. Last Name  
c. Company  
42 Depot Road  
d. Street Address  
Boxford  
e. City/Town  
MA  
f. State  
01921  
g. Zip Code  
9788876469  
h. Phone Number  
i. Fax Number  
richard.tomczyk@outlook.com  
j. Email address

5. Total WPA Fee Paid (from NOI Wetland Fee Transmittal Form):

FEE EXEMPT/Municipality  
a. Total Fee Paid  
Fee Exempt  
b. State Fee Paid  
Fee Exempt  
c. City/Town Fee Paid

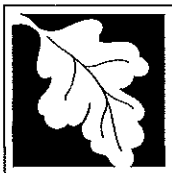

Massachusetts Department of Environmental Protection  
Bureau of Resource Protection - Wetlands

**WPA Form 3 – Notice of Intent**

Massachusetts Wetlands Protection Act M.G.L. c. 131, §40

Provided by MassDEP  
MassDEP File Number  
Document Transaction Number  
Boxford  
City/Town

**A. General Information (continued)**

6. General Project Description:

Construct 100 foot long elevated boardwalk over BVW and intermittent stream

7a. Project Type Checklist: (Limited Project Types see Section A. 7b.)

- 1.  Single Family Home
- 2.  Residential Subdivision
- 3.  Commercial/Industrial
- 4.  Dock/Pier
- 5.  Utilities
- 6.  Coastal engineering Structure
- 7.  Agriculture (e.g., cranberries, forestry)
- 8.  Transportation
- 9.  Other

7b. Is any portion of the proposed activity eligible to be treated as a limited project (including Ecological Restoration Limited Project) subject to 310 CMR 10.24 (coastal) or 310 CMR 10.53 (inland)?

1.  Yes  No If yes, describe which limited project applies to this project. (See 310 CMR 10.24 and 10.53 for a complete list and description of limited project types)

310 CMR 10.53(3)j, Catwalks, footbridges, etc.

2. Limited Project Type

If the proposed activity is eligible to be treated as an Ecological Restoration Limited Project (310 CMR 10.24(8), 310 CMR 10.53(4)), complete and attach Appendix A: Ecological Restoration Limited Project Checklist and Signed Certification.

8. Property recorded at the Registry of Deeds for:

Essex

a. County

33413

c. Book

b. Certificate # (if registered land)

523

d. Page Number

**B. Buffer Zone & Resource Area Impacts (temporary & permanent)**

- 1.  Buffer Zone Only – Check if the project is located only in the Buffer Zone of a Bordering Vegetated Wetland, Inland Bank, or Coastal Resource Area.
- 2.  Inland Resource Areas (see 310 CMR 10.54-10.58; if not applicable, go to Section B.3, Coastal Resource Areas).

Check all that apply below. Attach narrative and any supporting documentation describing how the project will meet all performance standards for each of the resource areas altered, including standards requiring consideration of alternative project design or location.



Massachusetts Department of Environmental Protection  
Bureau of Resource Protection - Wetlands

**WPA Form 3 – Notice of Intent**

Massachusetts Wetlands Protection Act M.G.L. c. 131, §40

Provided by MassDEP:  
MassDEP File Number \_\_\_\_\_  
Document Transaction Number \_\_\_\_\_  
Boxford  
City/Town

**B. Buffer Zone & Resource Area Impacts (temporary & permanent) (cont'd)**

For all projects affecting other Resource Areas, please attach a narrative explaining how the resource area was delineated.

Resource Area	Size of Proposed Alteration	Proposed Replacement (if any)
a. <input type="checkbox"/> Bank	1. linear feet _____	2. linear feet _____
b. <input checked="" type="checkbox"/> Bordering Vegetated Wetland	10 1. square feet _____	0 2. square feet _____
c. <input checked="" type="checkbox"/> Land Under Waterbodies and Waterways	15 1. square feet _____ 3. cubic yards dredged _____	2. square feet _____

Resource Area	Size of Proposed Alteration	Proposed Replacement (if any)
d. <input type="checkbox"/> Bordering Land Subject to Flooding	1. square feet _____ 3. cubic feet of flood storage lost _____	2. square feet _____ 4. cubic feet replaced _____
e. <input type="checkbox"/> Isolated Land Subject to Flooding	1. square feet _____ 2. cubic feet of flood storage lost _____	3. cubic feet replaced _____

- f.  Riverfront Area
1. Name of Waterway (if available) - specify coastal or inland \_\_\_\_\_
2. Width of Riverfront Area (check one):
- 25 ft. - Designated Densely Developed Areas only
  - 100 ft. - New agricultural projects only
  - 200 ft. - All other projects
3. Total area of Riverfront Area on the site of the proposed project: \_\_\_\_\_ square feet
4. Proposed alteration of the Riverfront Area:
- a. total square feet \_\_\_\_\_      b. square feet within 100 ft. \_\_\_\_\_      c. square feet between 100 ft. and 200 ft. \_\_\_\_\_

5. Has an alternatives analysis been done and is it attached to this NOI?       Yes  No
6. Was the lot where the activity is proposed created prior to August 1, 1996?       Yes  No

3.  Coastal Resource Areas: (See 310 CMR 10.25-10.35)

**Note:** for coastal riverfront areas, please complete **Section B.2.f.** above.



**Massachusetts Department of Environmental Protection  
Bureau of Resource Protection - Wetlands**

**WPA Form 3 – Notice of Intent**

Massachusetts Wetlands Protection Act M.G.L. c. 131, §40

Provided by MassDEP  
 \_\_\_\_\_  
 MassDEP File Number  
 \_\_\_\_\_  
 Document Transaction Number  
 Boxford  
 \_\_\_\_\_  
 City/Town

**B. Buffer Zone & Resource Area Impacts (temporary & permanent) (cont'd)**

Check all that apply below. Attach narrative and supporting documentation describing how the project will meet all performance standards for each of the resource areas altered, including standards requiring consideration of alternative project design or location.

Online Users:  
 Include your document transaction number (provided on your receipt page) with all supplementary information you submit to the Department.

<u>Resource Area</u>	<u>Size of Proposed Alteration</u>	<u>Proposed Replacement (if any)</u>
a. <input type="checkbox"/> Designated Port Areas	Indicate size under Land Under the Ocean, below	
b. <input type="checkbox"/> Land Under the Ocean	_____ 1. square feet	
	_____ 2. cubic yards dredged	
c. <input type="checkbox"/> Barrier Beach	Indicate size under Coastal Beaches and/or Coastal Dunes below	
d. <input type="checkbox"/> Coastal Beaches	_____ 1. square feet	_____ 2. cubic yards beach nourishment
e. <input type="checkbox"/> Coastal Dunes	_____ 1. square feet	_____ 2. cubic yards dune nourishment
	<u>Size of Proposed Alteration</u>	<u>Proposed Replacement (if any)</u>
f. <input type="checkbox"/> Coastal Banks	_____ 1. linear feet	
g. <input type="checkbox"/> Rocky Intertidal Shores	_____ 1. square feet	
h. <input type="checkbox"/> Salt Marshes	_____ 1. square feet	_____ 2. sq ft restoration, rehab., creation
i. <input type="checkbox"/> Land Under Salt Ponds	_____ 1. square feet	
	_____ 2. cubic yards dredged	
j. <input type="checkbox"/> Land Containing Shellfish	_____ 1. square feet	
k. <input type="checkbox"/> Fish Runs	Indicate size under Coastal Banks, inland Bank, Land Under the Ocean, and/or inland Land Under Waterbodies and Waterways, above	
	_____ 1. cubic yards dredged	
l. <input type="checkbox"/> Land Subject to Coastal Storm Flowage	_____ 1. square feet	
4. <input type="checkbox"/> Restoration/Enhancement	If the project is for the purpose of restoring or enhancing a wetland resource area in addition to the square footage that has been entered in Section B.2.b or B.3.h above, please enter the additional amount here.	
	_____ a. square feet of BVW	_____ b. square feet of Salt Marsh
5. <input type="checkbox"/> Project Involves Stream Crossings		
	_____ a. number of new stream crossings	_____ b. number of replacement stream crossings



Massachusetts Department of Environmental Protection  
Bureau of Resource Protection - Wetlands

**WPA Form 3 – Notice of Intent**

Massachusetts Wetlands Protection Act M.G.L. c. 131, §40

Provided by MassDEP:

MassDEP File Number

Document Transaction Number

Boxford

City/Town

**C. Other Applicable Standards and Requirements**

- This is a proposal for an Ecological Restoration Limited Project. Skip Section C and complete Appendix A: Ecological Restoration Limited Project Checklists – Required Actions (310 CMR 10.11).

**Streamlined Massachusetts Endangered Species Act/Wetlands Protection Act Review**

1. Is any portion of the proposed project located in **Estimated Habitat of Rare Wildlife** as indicated on the most recent Estimated Habitat Map of State-Listed Rare Wetland Wildlife published by the Natural Heritage and Endangered Species Program (NHESP)? To view habitat maps, see the *Massachusetts Natural Heritage Atlas* or go to [http://maps.massgis.state.ma.us/PRI\\_EST\\_HAB/viewer.htm](http://maps.massgis.state.ma.us/PRI_EST_HAB/viewer.htm).

- a.  Yes  No **If yes, include proof of mailing or hand delivery of NOI to:**

Natural Heritage and Endangered Species Program  
Division of Fisheries and Wildlife  
1 Rabbit Hill Road  
Westborough, MA 01581

August 1, 2017

b. Date of map

If yes, the project is also subject to Massachusetts Endangered Species Act (MESA) review (321 CMR 10.18). To qualify for a streamlined, 30-day, MESA/Wetlands Protection Act review, please complete Section C.1.c, and include requested materials with this Notice of Intent (NOI); OR complete Section C.2.f, if applicable. *If MESA supplemental information is not included with the NOI, by completing Section 1 of this form, the NHESP will require a separate MESA filing which may take up to 90 days to review (unless noted exceptions in Section 2 apply, see below).*

- c. Submit Supplemental Information for Endangered Species Review\*
1.  Percentage/acreage of property to be altered:
 

(a) within wetland Resource Area	<u>less than 0.1 percent, boardwalk posts</u> percentage/acreage
(b) outside Resource Area	<u>less than 0.1 percent, boardwalk posts</u> percentage/acreage
  2.  Assessor's Map or right-of-way plan of site
2.  Project plans for entire project site, including wetland resource areas and areas outside of wetlands jurisdiction, showing existing and proposed conditions, existing and proposed tree/vegetation clearing line, and clearly demarcated limits of work \*\*
- (a)  Project description (including description of impacts outside of wetland resource area & buffer zone)
  - (b)  Photographs representative of the site

\* Some projects **not** in Estimated Habitat may be located in Priority Habitat, and require NHESP review (see <http://www.mass.gov/eea/agencies/dfg/dfw/natural-heritage/regulatory-review/>). Priority Habitat includes habitat for state-listed plants and strictly upland species not protected by the Wetlands Protection Act.

\*\* MESA projects may not be segmented (321 CMR 10.16). The applicant must disclose full development plans even if such plans are not required as part of the Notice of Intent process.

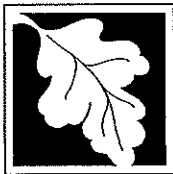

**Massachusetts Department of Environmental Protection**  
**Bureau of Resource Protection - Wetlands**

**WPA Form 3 – Notice of Intent**

Massachusetts Wetlands Protection Act M.G.L. c. 131, §40

Provided by MassDEP

MassDEP File Number

Document Transaction Number

Boxford

City/Town

**C. Other Applicable Standards and Requirements (cont'd)**

- (c)  MESA filing fee (fee information available at [http://www.mass.gov/dfwele/dfw/nhesp/regulatory\\_review/ mesa/ mesa\\_fee\\_schedule.htm](http://www.mass.gov/dfwele/dfw/nhesp/regulatory_review/ mesa/ mesa_fee_schedule.htm)).  
 Make check payable to "Commonwealth of Massachusetts - NHESP" and **mail to NHESP** at above address

*Projects altering 10 or more acres of land, also submit:*

- (d)  Vegetation cover type map of site
- (e)  Project plans showing Priority & Estimated Habitat boundaries
- (f) OR Check One of the Following

1.  Project is exempt from MESA review.  
 Attach applicant letter indicating which MESA exemption applies. (See 321 CMR 10.14, [http://www.mass.gov/dfwele/dfw/nhesp/regulatory\\_review/ mesa/ mesa\\_exemptions.htm](http://www.mass.gov/dfwele/dfw/nhesp/regulatory_review/ mesa/ mesa_exemptions.htm); the NOI must still be sent to NHESP if the project is within estimated habitat pursuant to 310 CMR 10.37 and 10.59.)

2.  Separate MESA review ongoing.                      a. NHESP Tracking #                      b. Date submitted to NHESP

3.  Separate MESA review completed.  
 Include copy of NHESP "no Take" determination or valid Conservation & Management Permit with approved plan.

3. For coastal projects only, is any portion of the proposed project located below the mean high water line or in a fish run?
- a.  Not applicable – project is in inland resource area only                      b.  Yes     No

If yes, include proof of mailing, hand delivery, or electronic delivery of NOI to either:

South Shore - Cohasset to Rhode Island border, and the Cape & Islands:

Division of Marine Fisheries -  
 Southeast Marine Fisheries Station  
 Attn: Environmental Reviewer  
 836 South Rodney French Blvd.  
 New Bedford, MA 02744  
 Email: [DMF.EnvReview-South@state.ma.us](mailto:DMF.EnvReview-South@state.ma.us)

North Shore - Hull to New Hampshire border:

Division of Marine Fisheries -  
 North Shore Office  
 Attn: Environmental Reviewer  
 30 Emerson Avenue  
 Gloucester, MA 01930  
 Email: [DMF.EnvReview-North@state.ma.us](mailto:DMF.EnvReview-North@state.ma.us)

Also if yes, the project may require a Chapter 91 license. For coastal towns in the Northeast Region, please contact MassDEP's Boston Office. For coastal towns in the Southeast Region, please contact MassDEP's Southeast Regional Office.



Massachusetts Department of Environmental Protection  
Bureau of Resource Protection - Wetlands

## WPA Form 3 – Notice of Intent

Massachusetts Wetlands Protection Act M.G.L. c. 131, §40

Provided by MassDEP

MassDEP File Number

Document Transaction Number

Boxford

City/Town

### C. Other Applicable Standards and Requirements (cont'd)

**Online Users:**  
Include your document transaction number (provided on your receipt page) with all supplementary information you submit to the Department.

4. Is any portion of the proposed project within an Area of Critical Environmental Concern (ACEC)?
- a.  Yes  No If yes, provide name of ACEC (see instructions to WPA Form 3 or MassDEP Website for ACEC locations). **Note:** electronic filers click on Website.
- b. ACEC
5. Is any portion of the proposed project within an area designated as an Outstanding Resource Water (ORW) as designated in the Massachusetts Surface Water Quality Standards, 314 CMR 4.00?
- a.  Yes  No
6. Is any portion of the site subject to a Wetlands Restriction Order under the Inland Wetlands Restriction Act (M.G.L. c. 131, § 40A) or the Coastal Wetlands Restriction Act (M.G.L. c. 130, § 105)?
- a.  Yes  No
7. Is this project subject to provisions of the MassDEP Stormwater Management Standards?
- a.  Yes. Attach a copy of the Stormwater Report as required by the Stormwater Management Standards per 310 CMR 10.05(6)(k)-(q) and check if:
1.  Applying for Low Impact Development (LID) site design credits (as described in Stormwater Management Handbook Vol. 2, Chapter 3)
  2.  A portion of the site constitutes redevelopment
  3.  Proprietary BMPs are included in the Stormwater Management System.
- b.  No. Check why the project is exempt:
1.  Single-family house
  2.  Emergency road repair
  3.  Small Residential Subdivision (less than or equal to 4 single-family houses or less than equal to 4 units in multi-family housing project) with no discharge to Critical Areas.

### D. Additional Information

- This is a proposal for an Ecological Restoration Limited Project. Skip Section D and complete Appendix A: Ecological Restoration Notice of Intent – Minimum Required Documents (310 CMR 10.12).

Applicants must include the following with this Notice of Intent (NOI). See instructions for details.

**Online Users:** Attach the document transaction number (provided on your receipt page) for any of the following information you submit to the Department.

1.  USGS or other map of the area (along with a narrative description, if necessary) containing sufficient information for the Conservation Commission and the Department to locate the site. (Electronic filers may omit this item.)
2.  Plans identifying the location of proposed activities (including activities proposed to serve as a Bordering Vegetated Wetland [BVW] replication area or other mitigating measure) relative to the boundaries of each affected resource area.



Massachusetts Department of Environmental Protection  
Bureau of Resource Protection - Wetlands

# WPA Form 3 – Notice of Intent

Massachusetts Wetlands Protection Act M.G.L. c. 131, §40

Provided by MassDEP

MassDEP File Number

Document Transaction Number

Boxford

City/Town

## D. Additional Information (cont'd)

3.  Identify the method for BVW and other resource area boundary delineations (MassDEP BVW Field Data Form(s), Determination of Applicability, Order of Resource Area Delineation, etc.), and attach documentation of the methodology.

4.  List the titles and dates for all plans and other materials submitted with this NOI.

Wildcat Conservtion Area Existing Conditions and Proposed Boardwalk

a. Plan Title

Donohoe Survey

Paul Donohoe, PLS

b. Prepared By

c. Signed and Stamped by

December 3, 2019

1" = 10'

d. Final Revision Date

e. Scale

Design of Boardwalk for the Wildcat Trail (Attachment F)

f. Additional Plan or Document Title

g. Date

5.  If there is more than one property owner, please attach a list of these property owners not listed on this form.

6.  Attach proof of mailing for Natural Heritage and Endangered Species Program, if needed.

7.  Attach proof of mailing for Massachusetts Division of Marine Fisheries, if needed.

8.  Attach NOI Wetland Fee Transmittal Form

9.  Attach Stormwater Report, if needed.

## E. Fees

1.  Fee Exempt: No filing fee shall be assessed for projects of any city, town, county, or district of the Commonwealth, federally recognized Indian tribe housing authority, municipal housing authority, or the Massachusetts Bay Transportation Authority.

Applicants must submit the following information (in addition to pages 1 and 2 of the NOI Wetland Fee Transmittal Form) to confirm fee payment:

2. Municipal Check Number

3. Check date

4. State Check Number

5. Check date

6. Payor name on check: First Name

7. Payor name on check: Last Name



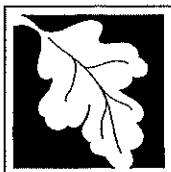

Massachusetts Department of Environmental Protection  
Bureau of Resource Protection - Wetlands

**WPA Form 3 – Notice of Intent**

Massachusetts Wetlands Protection Act M.G.L. c. 131, §40

Provided by MassDEP
MassDEP File Number
Document Transaction Number
Boxford
City/Town

**F. Signatures and Submittal Requirements**

I hereby certify under the penalties of perjury that the foregoing Notice of Intent and accompanying plans, documents, and supporting data are true and complete to the best of my knowledge. I understand that the Conservation Commission will place notification of this Notice in a local newspaper at the expense of the applicant in accordance with the wetlands regulations, 310 CMR 10.05(5)(a).

I further certify under penalties of perjury that all abutters were notified of this application, pursuant to the requirements of M.G.L. c. 131, § 40. Notice must be made by Certificate of Mailing or in writing by hand delivery or certified mail (return receipt requested) to all abutters within 100 feet of the property line of the project location.

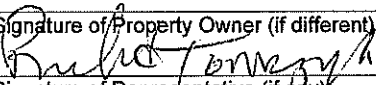
	<i>AVAN J. BENSON</i>
1. Signature of Applicant	Town Administrator / CPO
	<i>12-16-19</i>
2. Date	
	
3. Signature of Property Owner (if different)	
	<i>12-16-19</i>
4. Date	
5. Signature of Representative (if any)	6. Date

**For Conservation Commission:**

Two copies of the completed Notice of Intent (Form 3), including supporting plans and documents, two copies of the NOI Wetland Fee Transmittal Form, and the city/town fee payment, to the Conservation Commission by certified mail or hand delivery.

**For MassDEP:**

One copy of the completed Notice of Intent (Form 3), including supporting plans and documents, one copy of the NOI Wetland Fee Transmittal Form, and a **copy** of the state fee payment to the MassDEP Regional Office (see Instructions) by certified mail or hand delivery.

**Other:**

If the applicant has checked the "yes" box in any part of Section C, Item 3, above, refer to that section and the Instructions for additional submittal requirements.

The original and copies must be sent simultaneously. Failure by the applicant to send copies in a timely manner may result in dismissal of the Notice of Intent.



**Massachusetts Department of Environmental Protection**  
 Bureau of Resource Protection - Wetlands  
**NOI Wetland Fee Transmittal Form**  
 Massachusetts Wetlands Protection Act M.G.L. c. 131, §40

**Important:** When filling out forms on the computer, use only the tab key to move your cursor - do not use the return key.



**A. Applicant Information**

1. Location of Project:

Between Herrick Road and Stiles Pond Road Boxford  
 a. Street Address b. City/Town  
 Not Applicable - Fee Exempt FEE EXEMPT  
 c. Check number d. Fee amount

2. Applicant Mailing Address:

Alan Benson  
 a. First Name b. Last Name  
 Town of Boxford  
 c. Organization  
 7A Spofford Road  
 d. Mailing Address  
 Boxford MA 01921  
 e. City/Town f. State g. Zip Code  
 9788876000 ext 502 9788875361 abenson@town.boxford.ma.us  
 h. Phone Number i. Fax Number j. Email Address

3. Property Owner (if different):

a. First Name b. Last Name  
 c. Organization  
 d. Mailing Address  
 e. City/Town f. State g. Zip Code  
 h. Phone Number i. Fax Number j. Email Address

To calculate filing fees, refer to the category fee list and examples in the instructions for filling out WPA Form 3 (Notice of Intent).

**B. Fees**

Fee should be calculated using the following process & worksheet. **Please see Instructions before filling out worksheet.**

**Step 1/Type of Activity:** Describe each type of activity that will occur in wetland resource area and buffer zone.

**Step 2/Number of Activities:** Identify the number of each type of activity.

**Step 3/Individual Activity Fee:** Identify each activity fee from the six project categories listed in the instructions.

**Step 4/Subtotal Activity Fee:** Multiply the number of activities (identified in Step 2) times the fee per category (identified in Step 3) to reach a subtotal fee amount. Note: If any of these activities are in a Riverfront Area in addition to another Resource Area or the Buffer Zone, the fee per activity should be multiplied by 1.5 and then added to the subtotal amount.

**Step 5/Total Project Fee:** Determine the total project fee by adding the subtotal amounts from Step 4.

**Step 6/Fee Payments:** To calculate the state share of the fee, divide the total fee in half and subtract \$12.50. To calculate the city/town share of the fee, divide the total fee in half and add \$12.50.



**Massachusetts Department of Environmental Protection**  
 Bureau of Resource Protection - Wetlands  
**NOI Wetland Fee Transmittal Form**  
 Massachusetts Wetlands Protection Act M.G.L. c. 131, §40

**B. Fees (continued)**

Step 1/Type of Activity	Step 2/Number of Activities	Step 3/Individual Activity Fee	Step 4/Subtotal Activity Fee
Boardwalk	1	Municipality Exempt	

**Step 5/Total Project Fee:** \_\_\_\_\_

**Step 6/Fee Payments:**

Total Project Fee:	NA/-Exempt - Town
State share of filing Fee:	a. Total Fee from Step 5
City/Town share of filing Fee:	N/A
	b. 1/2 Total Fee less \$12.50
	N/A
	c. 1/2 Total Fee plus \$12.50

**C. Submittal Requirements**

- a.) Complete pages 1 and 2 and send with a check or money order for the state share of the fee, payable to the Commonwealth of Massachusetts.

Department of Environmental Protection  
 Box 4062  
 Boston, MA 02211

- b.) **To the Conservation Commission:** Send the Notice of Intent or Abbreviated Notice of Intent; a copy of this form; and the city/town fee payment.

**To MassDEP Regional Office (see Instructions):** Send a copy of the Notice of Intent or Abbreviated Notice of Intent; a copy of this form; and a copy of the state fee payment. (E-filers of Notices of Intent may submit these electronically.)

**Wildcat Conservation Land, Boxford, Trail, Footbridge/Boardwalk project description.**

This project is the construction of a wooden elevated footbridge/boardwalk at the Wildcat Conservation Land, Boxford and will replace the existing footbridge that is only passable a portion of the year. The proposed elevated boardwalk will provide access to the existing trails on the Wildcat Conservation land. This crossing allows full use of the train system and is a part of the main trail that goes from one end of the conservation area at Herrick Road to the other end at Stiles Pond Road.

The boardwalk will be constructed of marine grade ACQ pressure treated wood. It will be elevated over the wetland by approximately 30 inches.

The following is a description of the construction process as described by the builder: "The layout of the boardwalk will be established by setting stakes and strings across the Bordering Vegetated Wetland. Working in the wetland, boots and waders will keep us dry, and we expect to use saw horses and planks to make temporary staging for post setting. At each end of the boardwalk, on dry land, we will hand dig holes to a minimum of three feet of depth, or to an immovable stone. A length of straw-filled mesh erosion control tube can be used to surround each dig. Posts set in the wetland will be pointed at ends and hand driven using a two-person driver. It is a steel box, about 65 pounds, with capped end and "D" handles on two sides. We drive posts through the wetland soils, until we meet material we cannot move through."

The alignment of the proposed boardwalk has been carefully considered and crosses the Bordering Vegetated Wetland at its narrowest point.

We have indicated on the NOI form that this project could qualify for a limited project per 310 CMR 10.53(3) j. catwalks, footbridges. To qualify for a limited project the Conservation Commission shall consider reasonable alternatives analysis is required for the limited project and we offer the following analysis:

In order to allow continued use of the trail on town owned Wildcat Conservation land, the existing footbridge will be replaced by the proposed footbridge. The alignment will cross the wetland at its narrowest point. A crossing upstream or downstream of the selected location will require a much longer crossing and would be located further from the existing trail system and would require cutting a new trail. The boardwalk will be elevated to avoid flooding of the footbridge during high water conditions. Alteration of the buffer zone and wetland resource area will be minimized by doing all the work by hand (no heavy equipment) to install the boardwalk support posts into the ground. The work will move in a progression from upland to the wetland and working from the boardwalk deck as it being constructed.

USGS Topo Map of Project Site Locus

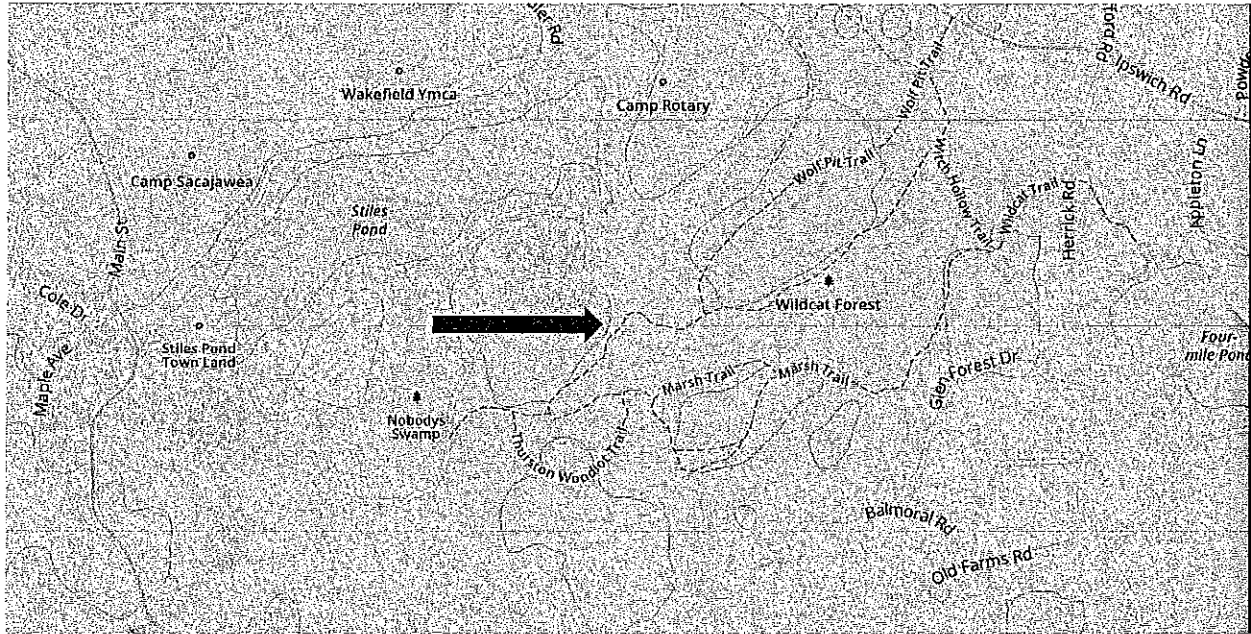

**MassDEP Bordering Vegetated Wetland (310 CMR 10.55) Delineation Field Data Form**

Applicant: Richard Tomczyk Prepared by: Greg Hochmuth Project location: Wildcat, Boxford MA DEP File #: \_\_\_\_\_

Check all that apply:

- Vegetation alone presumed adequate to delineate BVW boundary: fill out Section I only
- Vegetation and other indicators of hydrology used to delineate BVW boundary: fill out Sections I and II
- Method other than dominance test used (attach additional information)

**Section I.**

Vegetation	Observation Plot Number: WFB-6 Up		Transect Number: WFB-6 Upland	Date of Delineation: 8/12/2019
A. Sample Layer & Plant Species (by common/scientific name)	B. Percent Cover (or basal Area)	C. Percent Dominance	D. Dominant Plant (yes or no)	E. Wetland Indicator Category*
<b>Trees</b>				
Red Oak – <i>Quercus rubra</i>	30%	30%	YES	FACU-
Red Maple - <i>Acer rubrum</i>	50%	50%	YES	FAC*
Hemlock – <i>Tsuga canadensis</i>	20%	20%	YES	FACU*
<b>Shrubs</b>				
Pepper-bush - <i>Clethra alnifolia</i>	40%	47%	YES	FAC+*
HighBush Blueberry – <i>Vaccinium corymbosum</i>	30%	35%	YES	FACW-*
Hemlock – <i>Tsuga canadensis</i>	15%	20%	YES	FACU
<b>Ground Cover</b>				
Partridgeberry – <i>Mitchella repens</i>	20%	57%	YES	FACU
Canada Mayflower – <i>Mainathemum canadense</i>	15%	42%	YES	FAC-

\* Use an asterisk to mark wetland indicator plants: plant species listed in the Wetlands Protection Act (MGL c.131, s.40); plants in the genus *Sphagnum*; plants listed as FAC, FAC+, FACW-, FACW, FACW+, or OBL; or plants with physiological or morphological adaptations. If any plants are identified as wetland indicator plants due to physiological or morphological adaptations, describe the adaptation next to the asterisk.

**Vegetation conclusion:**

Number of dominant wetland indicator plants: 4

Number of dominant non-wetland indicator plants: 4

Is the number of dominant wetland plants equal to or greater than the number of dominant non-wetland plants? Yes

If vegetation alone is presumed adequate to delineate the BVW boundary, submit this form with the Request for Determination of Applicability or Notice of Intent.

**Section II. Indicators of Hydrology**

**Hydric Soil Interpretation**

**1. Soil Survey**

Is there a published soil survey for this site? Yes  
 title/date: NRCS Web Soil Survey  
 map number: -  
 soil type mapped: 717E – Charlton outcrop-Charlton-Hollis complex  
 hydric soil inclusions: No

Are field observations consistent with soil survey? Yes  
 Remarks:

**2. Soil Description**

Horizon	Depth	Matrix Color	Mottles Color
A	0-10	10YR3/2	-
Bw	10-18	7.5YR5/6	

Remarks:

**3. Other:**

Conclusion: Is soil hydric? No

**Other Indicators of Hydrology: (check all that apply & describe)**

- Site Inundated: \_\_\_\_\_
- Depth to free water in observation hole: \_\_\_\_\_
- Depth to soil saturation in observation hole: \_\_\_\_\_
- Water marks: \_\_\_\_\_
- Drift lines: \_\_\_\_\_
- Sediment Deposits: \_\_\_\_\_
- Drainage patterns in BVW: \_\_\_\_\_
- Oxidized rhizospheres: \_\_\_\_\_
- Water-stained leaves: \_\_\_\_\_
- Recorded Data (streams, lake, or tidal gauge; aerial photo; other):  
 \_\_\_\_\_  
 \_\_\_\_\_
- Other: \_\_\_\_\_

Vegetation and Hydrology Conclusion		
	Yes	No
Number of wetland indicator plants ≥ # of non-wetland indicator plants	_X_	___
<b>Wetland hydrology present:</b>		
Hydric soil present	___	_X_
Other indicators of hydrology present	___	_X_
Sample location is in a BVW	___	_X_
<small>Submit this form with the Request for Determination of Applicability or Notice of Intent.</small>		

**MassDEP Bordering Vegetated Wetland (310 CMR 10.55) Delineation Field Data Form**

Applicant: Richard Tomczyk Prepared by: Greg Hochmuth Project location: Wildcat, Boxford MA DEP File #: \_\_\_\_\_

Check all that apply:

- Vegetation alone presumed adequate to delineate BVW boundary: fill out Section I only
- Vegetation and other indicators of hydrology used to delineate BVW boundary: fill out Sections I and II
- Method other than dominance test used (attach additional information)

**Section I.**

Vegetation	Observation Plot Number: WFB-6 Wet		Transect Number: WFB-6 Wetland	Date of Delineation: 8/12/2019
A. Sample Layer & Plant Species (by common/scientific name)	B. Percent Cover (or basal Area)	C. Percent Dominance	D. Dominant Plant (yes or no)	E. Wetland Indicator Category*
<b>Trees</b>				
Red Oak – <i>Quercus rubra</i>	10%	10%	NO	FACU-
Red Maple - <i>Acer rubrum</i>	60%	60%	YES	FAC*
Hemlock – <i>Tsuga canadensis</i>	30%	30%	YES	FACU*
<b>Shrubs</b>				
Pepper-bush - <i>Clethra alnifolia</i>	30%	60%	YES	FAC+*
HighBush Blueberry – <i>Vaccinium corymbosum</i>	20%	40%	YES	FACW-*
<b>Ground Cover</b>				
Skunk Cabbage – <i>Symplocarpus foetidus</i>	10%	28%	YES	OBL*
Sensitive Fern – <i>Onoclea sensibilis</i>	25%	71%	YES	FACW*

\* Use an asterisk to mark wetland indicator plants: plant species listed in the Wetlands Protection Act (MGL c.131, s.40); plants in the genus *Sphagnum*; plants listed as FAC, FAC+, FACW-, FACW, FACW+, or OBL; or plants with physiological or morphological adaptations. If any plants are identified as wetland indicator plants due to physiological or morphological adaptations, describe the adaptation next to the asterisk.

**Vegetation conclusion:**

Number of dominant wetland indicator plants: 6

Number of dominant non-wetland indicator plants: 0

Is the number of dominant wetland plants equal to or greater than the number of dominant non-wetland plants? Yes

If vegetation alone is presumed adequate to delineate the BVW boundary, submit this form with the Request for Determination of Applicability or Notice of Intent.



**Section II. Indicators of Hydrology**

**Hydric Soil Interpretation**

**1. Soil Survey**

Is there a published soil survey for this site? Yes  
 title/date: NRCS Web Soil Survey  
 map number: -  
 soil type mapped: 52A – Freetown Muck  
 hydric soil inclusions: Yes

Are field observations consistent with soil survey? Yes  
 Remarks:

**2. Soil Description**

Horizon	Depth	Matrix Color	Mottles Color
O	6-0	-	-
C	0-18	5Y5/2	10YR5/2

Remarks:

**3. Other:**

Conclusion: Is soil hydric? Yes

**Other Indicators of Hydrology: (check all that apply & describe)**

- Site Inundated: \_\_\_\_\_
- Depth to free water in observation hole: \_\_\_\_\_
- Depth to soil saturation in observation hole: \_\_\_\_\_
- Water marks: \_\_\_\_\_
- Drift lines: \_\_\_\_\_
- Sediment Deposits: \_\_\_\_\_
- Drainage patterns in BVW: \_\_\_\_\_
- Oxidized rhizospheres: \_\_\_\_\_
- Water-stained leaves: \_\_\_\_\_
- Recorded Data (streams, lake, or tidal gauge; aerial photo; other):  
 \_\_\_\_\_  
 \_\_\_\_\_  
 \_\_\_\_\_
- Other: \_\_\_\_\_

Vegetation and Hydrology Conclusion		
	Yes	No
Number of wetland indicator plants ≥ # of non-wetland indicator plants	_X_	__
<b>Wetland hydrology present:</b>		
Hydric soil present	_X_	__
Other indicators of hydrology present	_X_	__
<b>Sample location is in a BVW</b>	_X_	__

*Submit this form with the Request for Determination of Applicability or Notice of Intent.*

NHESP Estimated Habitat and Approximate Project Location

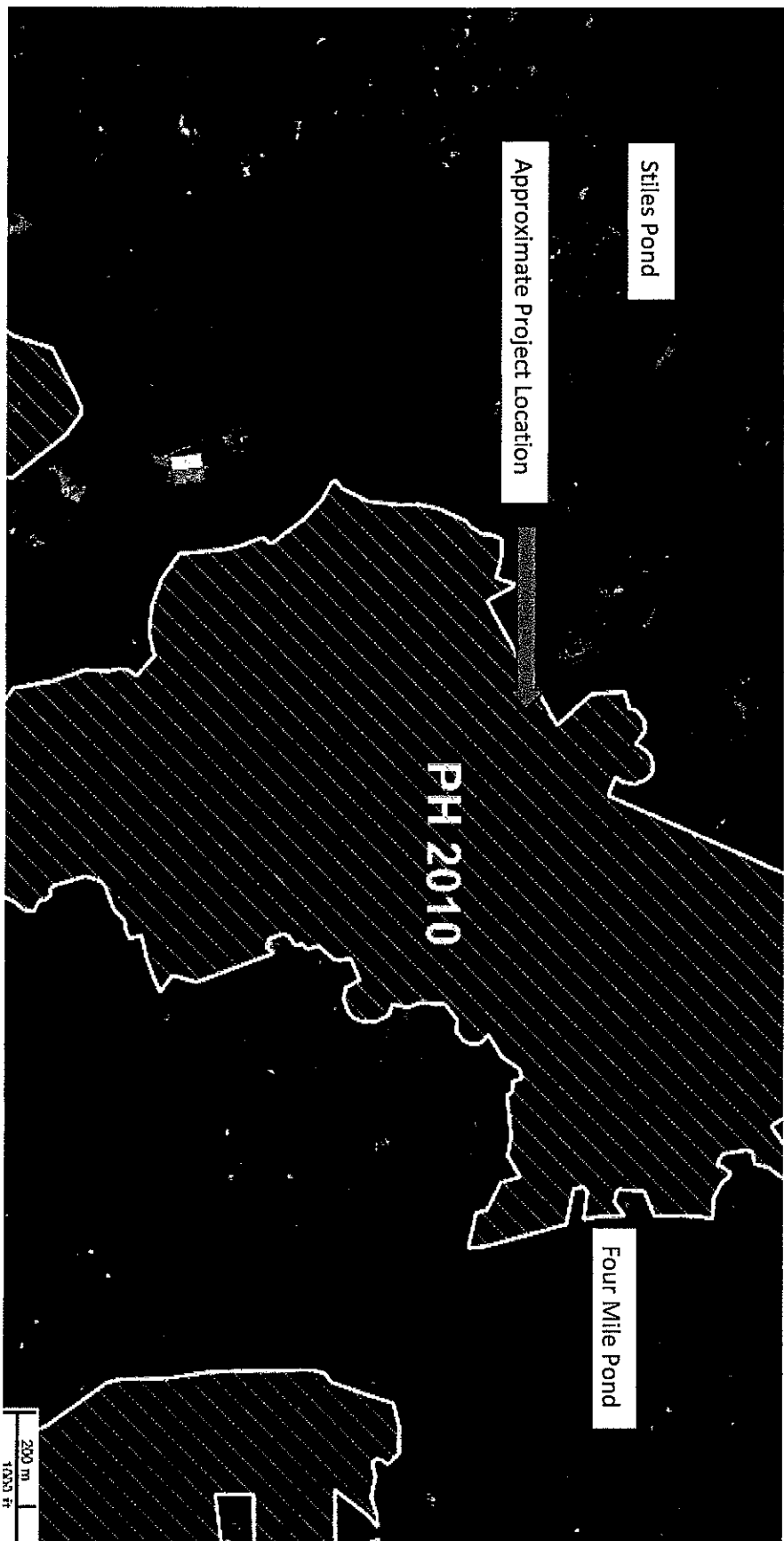

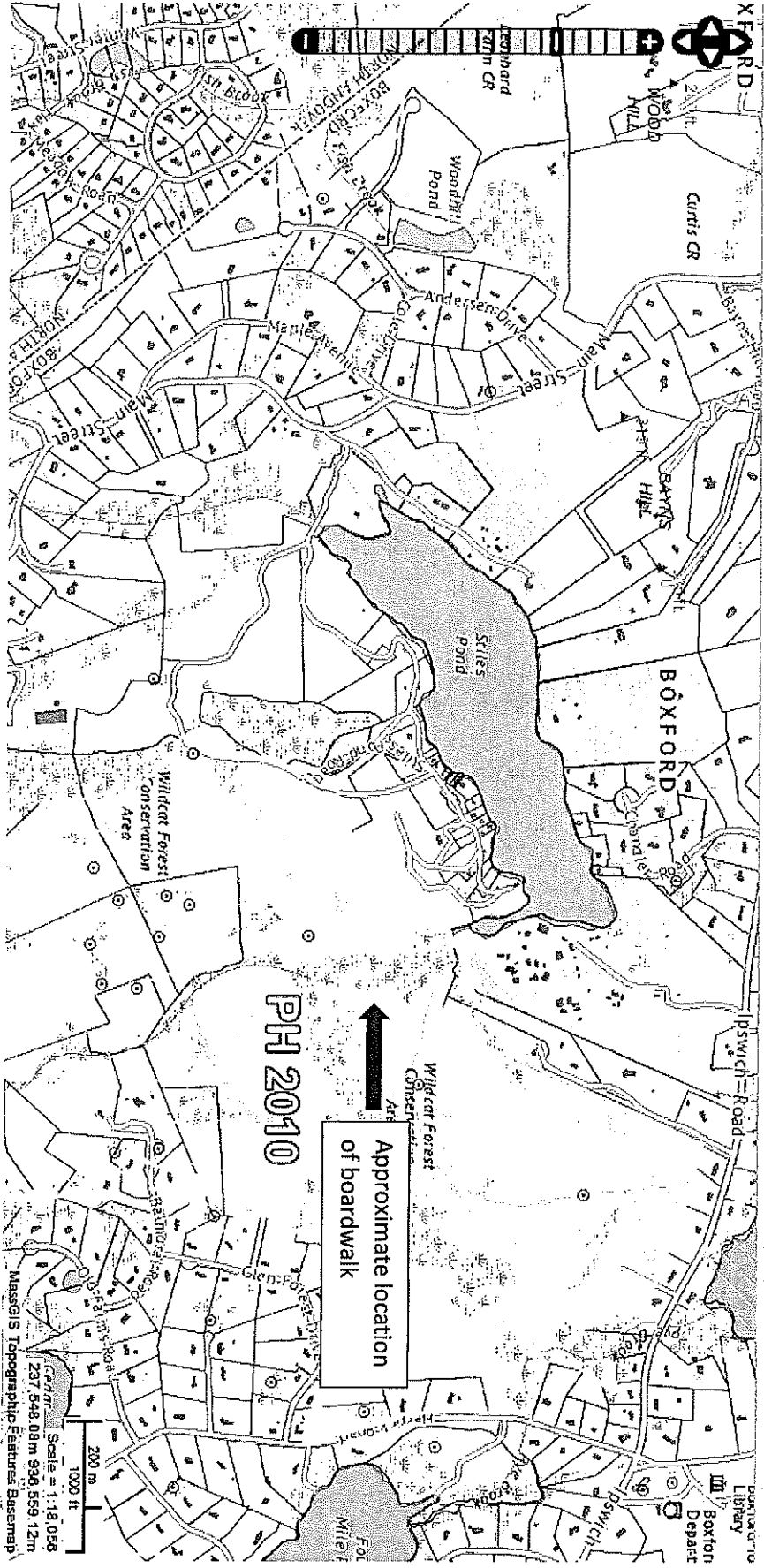

A Hazelden FE

# Attachment F

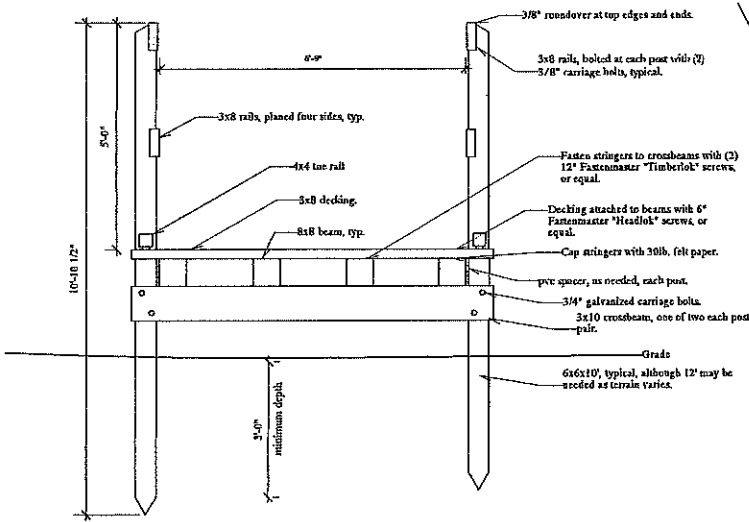

Section drawing.  
Scale: 1/2" = 1'.

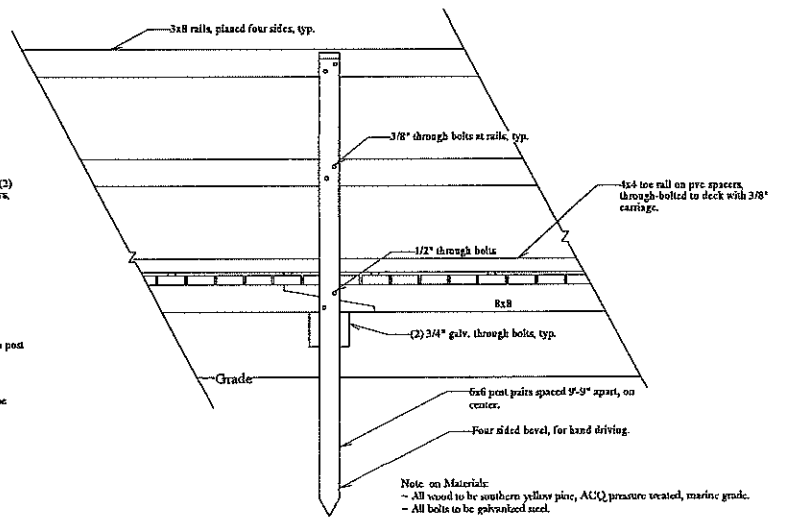

Elevation detail, typical of each post.  
Scale: 1/2" = 1'.

## Design of a Boardwalk for the Wildcat Trail Boxford, Massachusetts

**Assessor's Map**

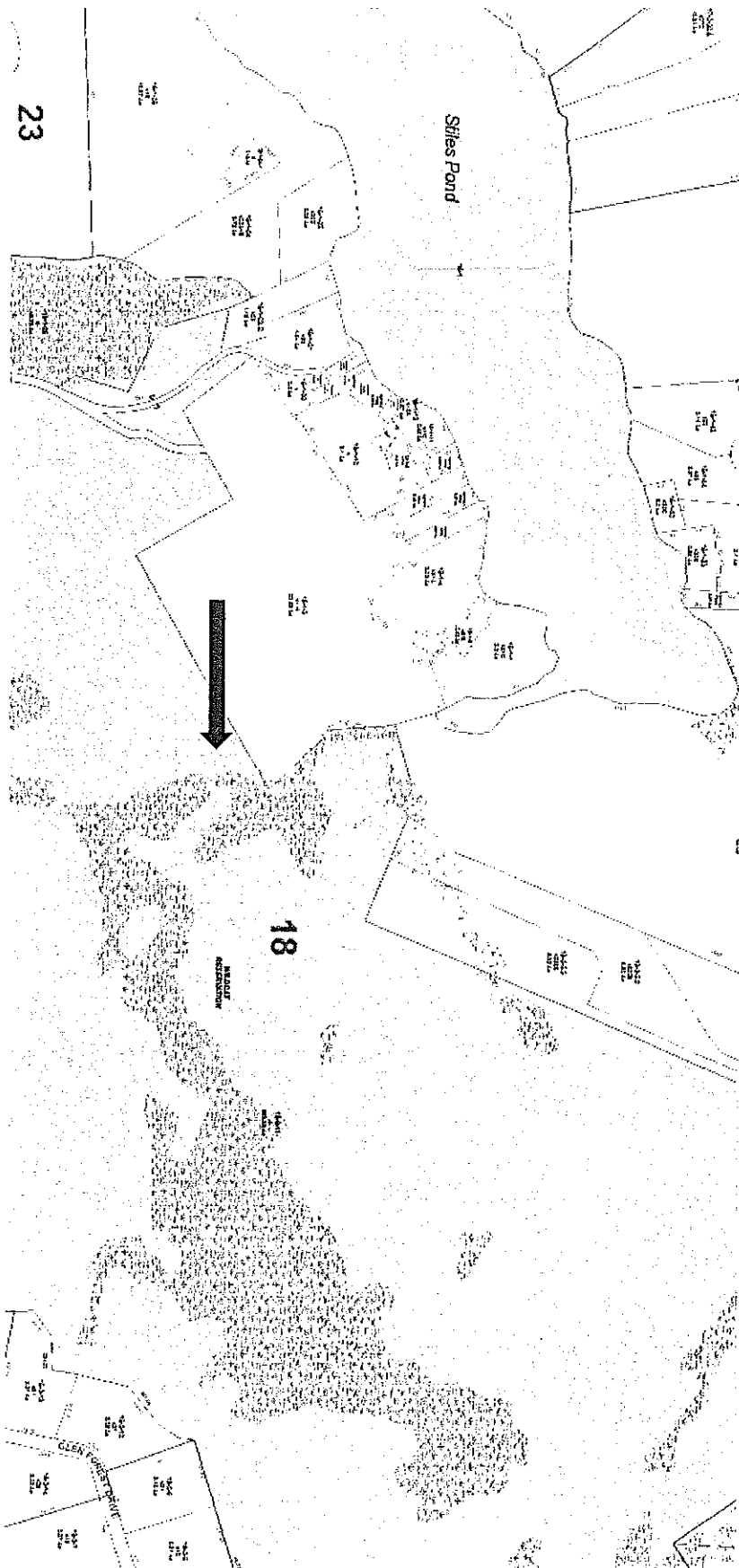

Arrow indicates approximate location of new boardwalk

D.W.P. & M.F.A. 2, REPER  
 MAP TO BLOCK 1, LOT 2

NOTE:  
 - SITE CONSISTS OF WOODED LAND EXCEPT  
 - FOR AREAS WITHIN THE PARKS & RECREATION

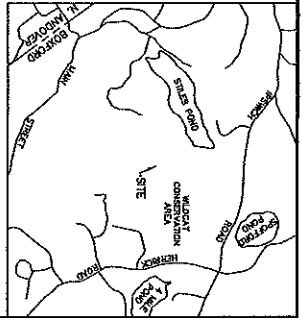
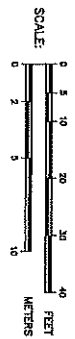
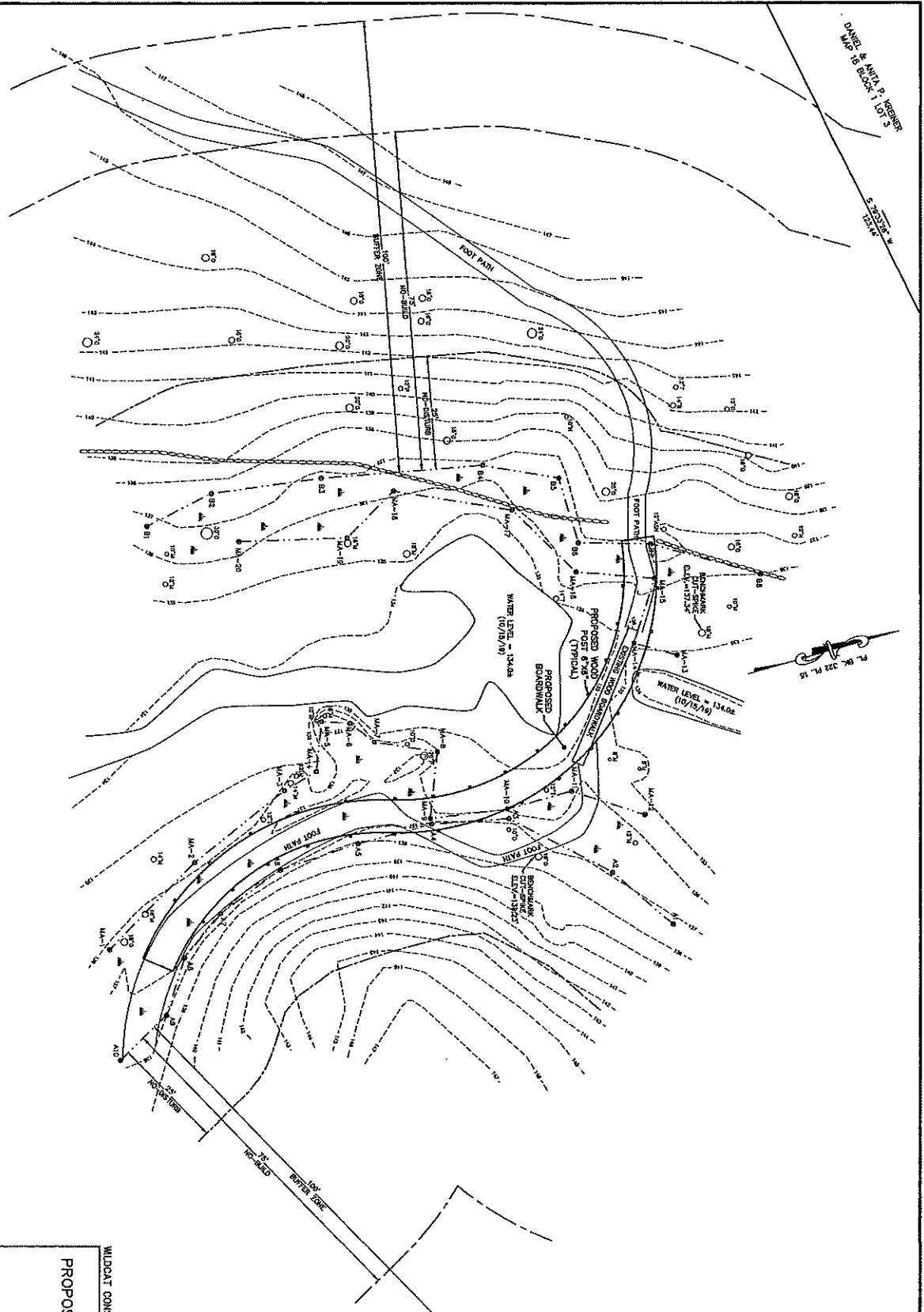

ASSESSORS: MAP 18, BLOCK 2, LOT 11  
 REFERENCE:  
 PLAN - PL. BK. 322, P.L. 15  
 VERTICAL DATUM: APPROXIMATE N.A.S.D. 1988  
 WETLAND DELINEATION: GREGORY HOCKMUTH  
 (AUGUST 2019)

**LEGEND & SYMBOLS**

ELEV.	ELEVATION
A & B	WETLAND FLAG (B.W)
MA	ISLAND BANK FLAG
O	OAK
M	MAPLE
P	PINE
H	HEDLOCK
T	TREE
B	BIRCH

WILDCAT CONSERVATION AREA  
 EXISTING CONDITIONS &  
 PROPOSED REPLACEMENT BOARDWALK  
 IN  
**BOXFORD, MA**  
 PROPERTY OF  
 TOWN OF BOXFORD  
 SCALE: 1" = 10'  
 DECEMBER 3, 2019  
 DONOHUE SURVEY, INC.  
 363 BOSTON ST.  
 TOPSFIELD, MA  
 (978) 897-6161  
 PROJ. 2388

*Attalment #*



