

# Variance Requests

Regulation	State	Local	Request
Alternative To Percolation Test (310 CMR 15.104)	Percolation Test		Use Sieve Analysis Per DEP Policy # BRP/DWM/PeP-P00-4

### Impervious Barrier:

Use High Density Polyethylene (HDPE) Barrier or Equivalent, 40 Mil Thick.

Top Elev. = 113.5'  
Bottom Elev. = 106.8' - 108.4' (varies)

Bottom of barrier shall extend to a minimum depth of at least one foot into existing parent material.

Barrier shall be installed at least 5' from leach bed. Backfill with clean fill with stones no larger than 3" diameter.

Percolation Rate: See Sieve Analysis Performed By UTS of MASS, Inc. Dated 7/26/05 On Samples Taken From Test Pit 1  
Sieve Analysis Results: Uncompacted Class I, Loamy Sand  
Use Loading Rate of 0.66 G.P.D./S.F.

10'x18' SHED PLACEMENT  
6 Lawrence Rd

### Soil Logs

Date Performed: July 8, 2005

Performed By: Greg Hochmuth (The Neve-Morin Group, Inc.)  
Witnessed By: Kendal Longo (Boxford BOM)

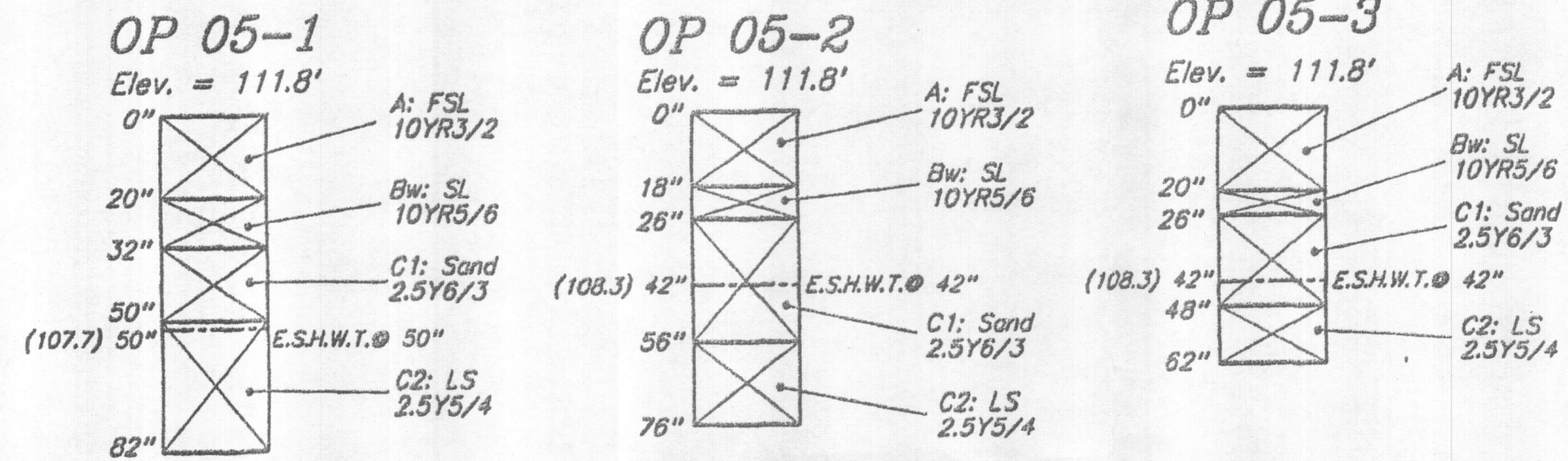

Benchmark  
Paintmark On Rock  
Elev. = 105.47'

Benchmark  
Nail In Tree Root  
Elevation = 114.41'

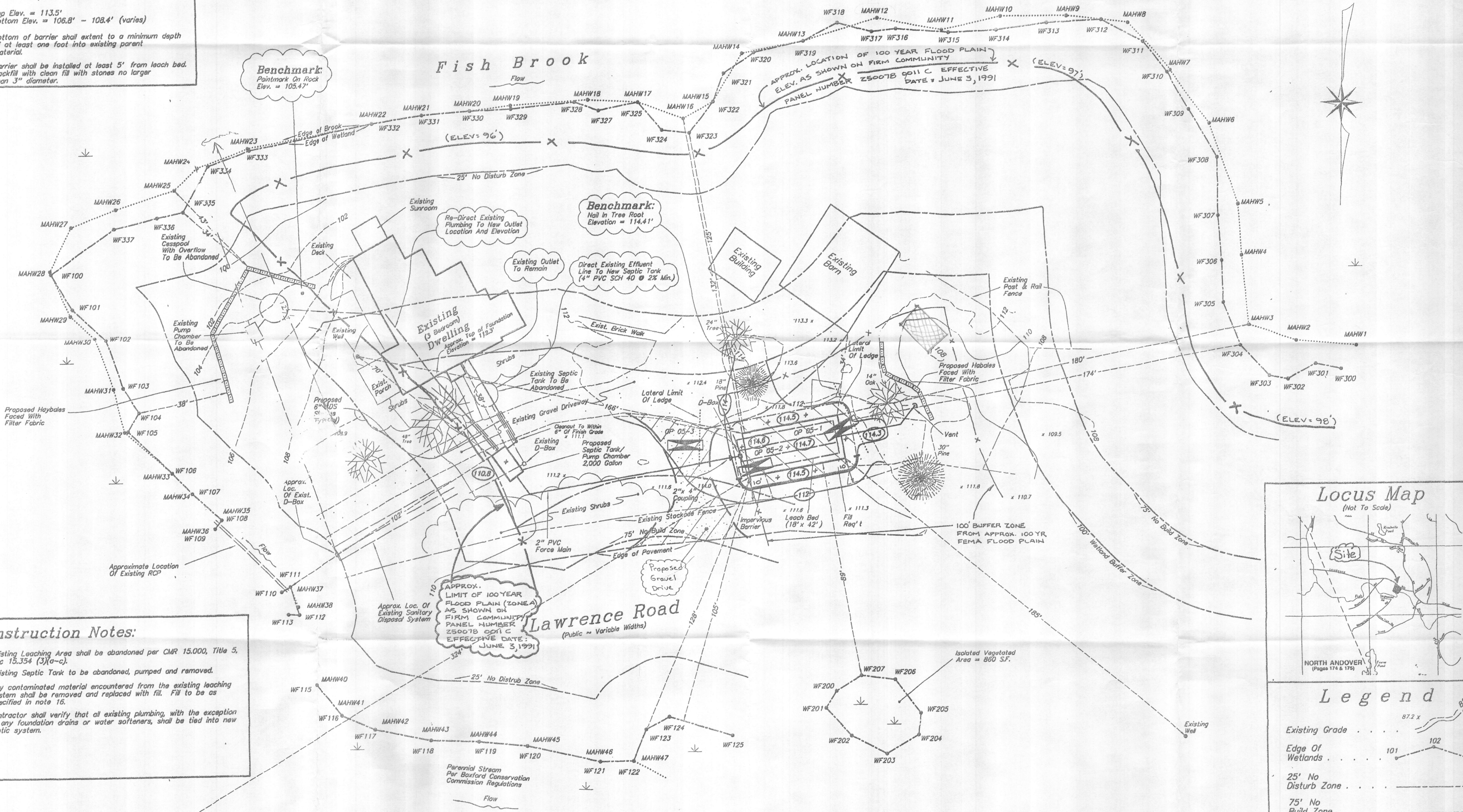

### Construction Notes:

- Existing Leaching Area shall be abandoned per CMR 15.000, Title 5, Sec 15.354 (3)(a-c).
- Existing Septic Tank to be abandoned, pumped and removed.
- Any contaminated material encountered from the existing leaching system shall be removed and replaced with fill. Fill to be as specified in note 16.
- Contractor shall verify that all existing plumbing, with the exception of any foundation drains or water softeners, shall be tied into new septic system.

Existing Location of Leaching Facilities & Components Taken From A Title 5 Inspection Prepared By Timothy White, Dated 4/30/05

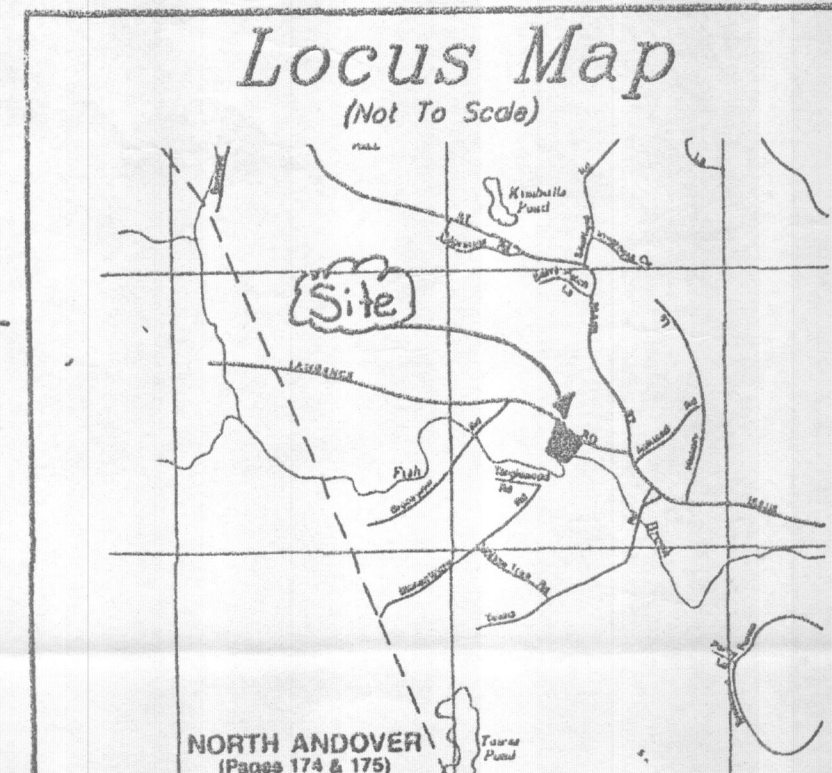

### Legend

- Existing Grade . . . . . 87.2 x
- Edge Of Wetlands . . . . . 101 102 103
- 25' No Disturb Zone . . . . .
- 75' No Build Zone . . . . .
- 100' Wetland Buffer Zone . . . . .
- Continuous Row Of Staked Hay Bales Faced With Filter Fabric . . . . .

Plan  
Scale: 1" = 20'

THE NEVE-MORIN GROUP, INC.  
Engineers - Surveyors - Environmental Consultants - Land Use Planners  
447 Old Boston Road - U.S. Route 1  
Topsfield, Massachusetts 01983  
Telephone Number: 978-887-8566  
Facsimile Number: 978-887-3460



Designed By: J.M.M.  
Drafted By: J.M.M.  
Checked By: J.M.M.  
Scale: As Noted  
Date: August 3, 2005

No.	Description	Date
1	ADD NORTH ARROW AND FLOOD PLAIN	8/12/05
2	SHOW 100' BY FROM 100YR FLOOD PLAIN	8/22/05
3	ADD NEW ENTRANCE	11/16/05

Sanitary Disposal System Upgrade  
Designed For  
**Tom Russell**  
6 Lawrence Road  
Boxford, Massachusetts

Drawing No. S-2372-1  
Sheet No. 1 Of 2