

PUMP CRITERIA:

No. OF DOSES/DAY 660 GPD/6 = 110 GAL + BACKFLOW
 BACKFLOW: 33' x (3.14159x(1/12)²x2)x7.48 = 6 GAL
 TOTAL DOSE = 110 + 6 = 116 GAL
 VOLUME OF DOSE = 116 GAL/7.48 GAL/CU FT = 16 FT³
 DEPTH OF DOSE = 16 FT³/3/2.9 FT³/INCH DEPTH IN
 1000 GAL PUMP CHAMBER = 5.5 INCHES USE 6" PER CYCLE.
HEAD CALCULATIONS:
 STATIC HEAD = 8' RISE PUMP OFF TO D-BOX IN V
 DYNAMIC HEAD (FRICTION LOSS)
 EQ LENGHT 1-90' @ 3.1' CHECK VALVE 1.7'
 GATE VALVE = 2.6' 2-45' = 6' TOTAL = 13.4'
 TOTAL D.H. = (33' + 13.4) x 5.4 / 100 @ 50 GPM = 3'
 TOTAL HEAD = 8' + 3' = 11' FT

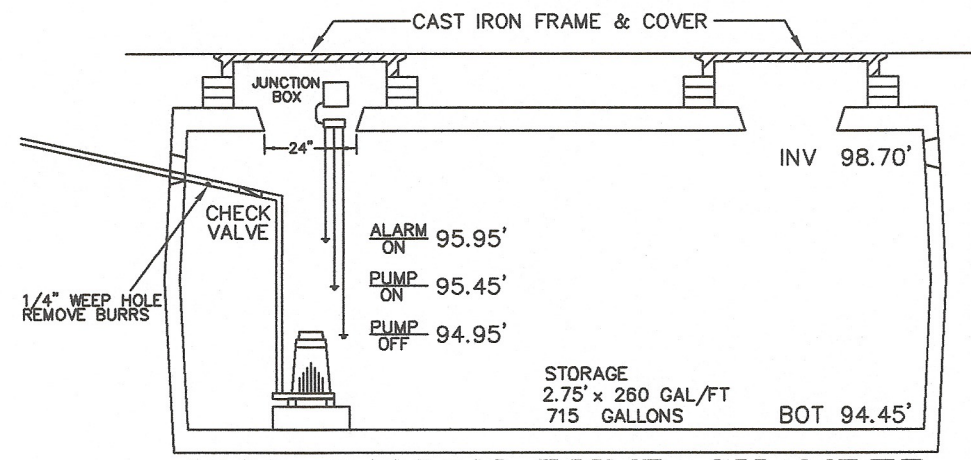

1000 GALLON PUMP CHAMBER (MONOLITHIC - H-20 LOAD)

USE STANDARD SEPTIC TANKS OF PUMP CHAMBERS PUMP, PLUMBING & ELECTRICAL BY OTHERS

PUMP CONTROLS:

PUMP CONTROLS SHALL BE MOISTURE PROOF AND OPERATE IN THE SEQUENCE SHOWN. THE CONTROLS SHALL INCLUDE AN AUDIO/VISUAL ALARMS, ALARM SILENCING SWITCH, MAIN POWER HAND SHUTOFF. ALARM SYSTEM SHALL BE POWERED BY A CIRCUIT SEPARATE FROM PUMP POWER.

CONTROL BOX AND ELECTRICAL WIRING SHALL BE INSTALLED IN ACCORDANCE WITH MANUFACTURER'S SPECIFICATIONS AND IN FULL COMPLIANCE WITH ALL STATE AND LOCAL REGULATIONS.

UPON COMPLETION, THE INSTALLATION SHALL BE TESTED TO INSURE PROPER OPERATION.

PUMP RATING CURVE:

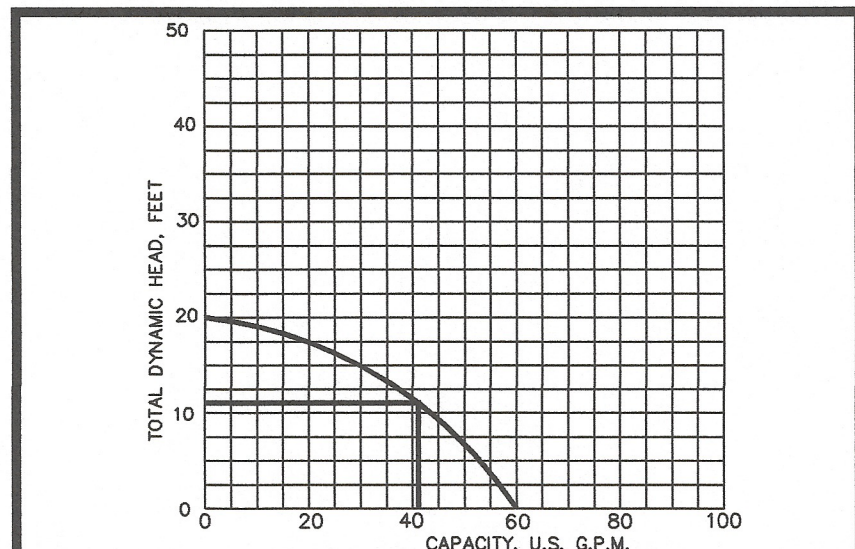

USE LIBERTY PUMP MODEL No. FL31A
 CAPACITY 42 G.P.M. AT 11' FEET T.D.H.

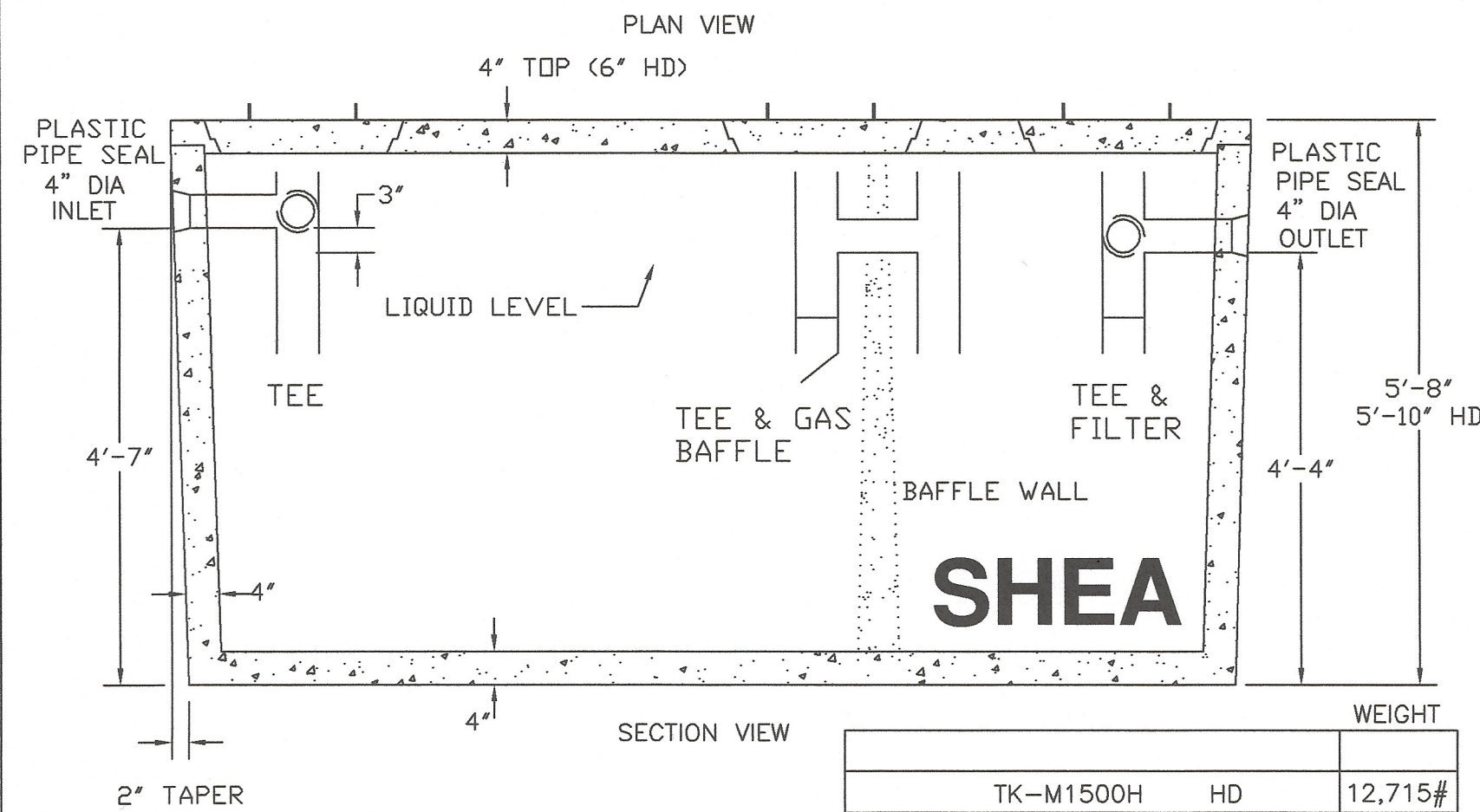
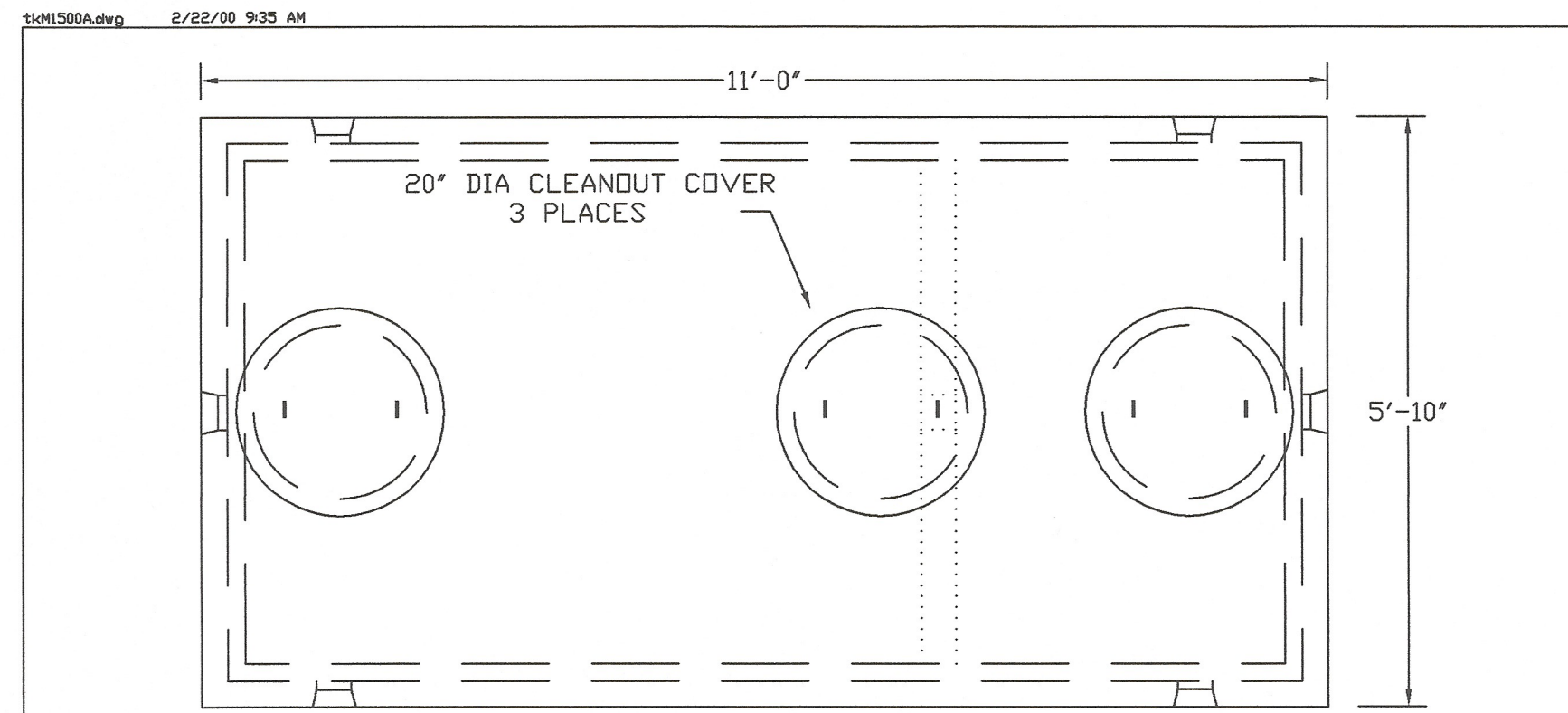

Model	Material	Weight
TK-M1500H	HD	12,715#
TK-M15002CH	HD	13,320#

NOTES:

- CONCRETE: 4,000 PSI MINIMUM AFTER 28 DAYS.
- DESIGN CONFORMS WITH 310 CMR 15.00, DEP TITLE 5 REGS, FOR SEPTIC TANKS.
- ALL REINFORCEMENT PER ASTM C1227-93.
- BAFFLE WALL OPTIONAL FOR TWO COMPARTMENT TANKS.
- TEES AND GAS BAFFLE SOLD SEPARATELY.
- TONGUE & GROOVE JOINT SEALED WITH BUTYLE RESIN.
- ALSO AVAILABLE IN H-20 LOADING.

WILMINGTON, MA (978) 658-2645 -- AMESBURY, MA (978) 388-1509
 NOTTINGHAM, NH (603) 942-5668

E.F. SHEA
 NEW ENGLAND
 CONCRETE PRODUCTS, INC.
 SEPTIC TANK MONOLITHIC
 1500 GALLON
 2 COMPARTMENT

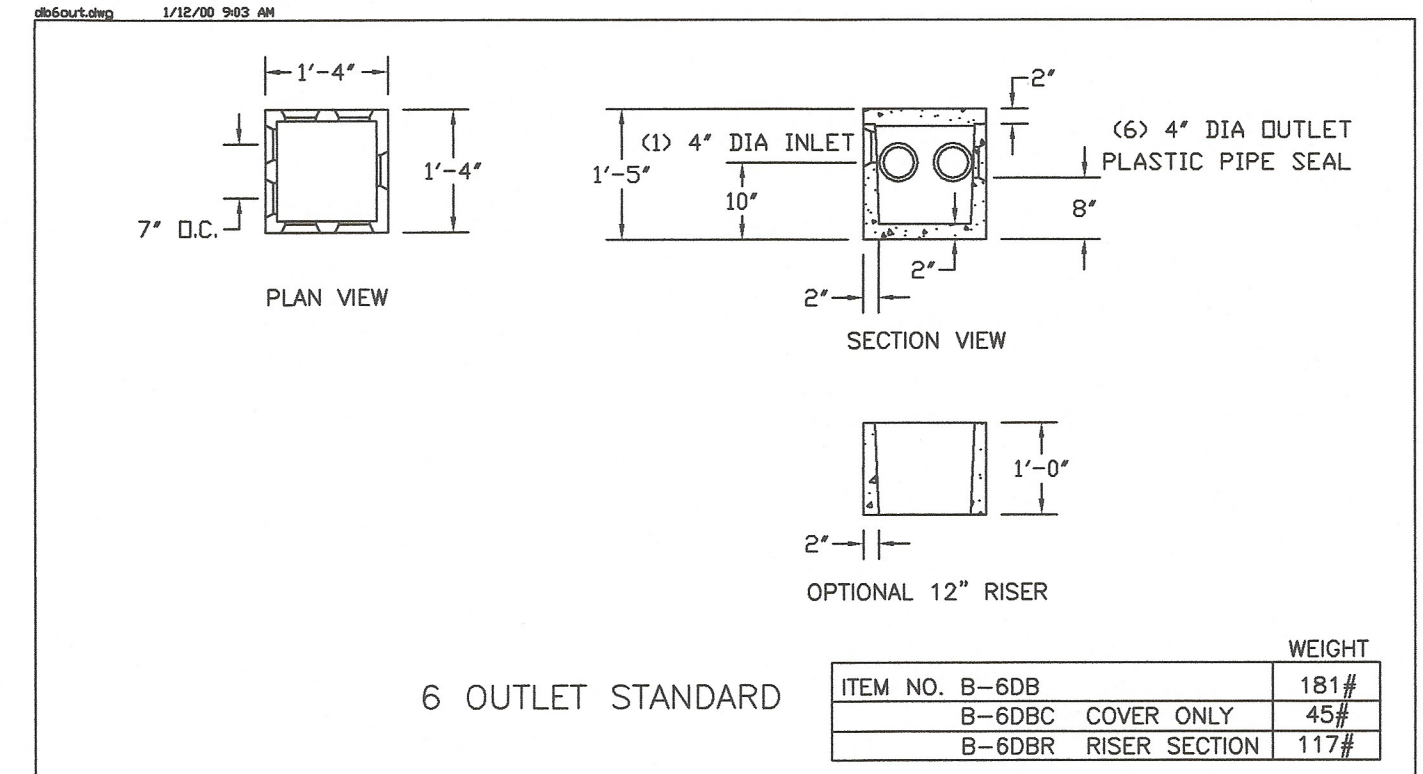

Item No.	Description	Weight
B-6DB	STANDARD	181#
B-6DBC	COVER ONLY	45#
B-6DBR	RISER SECTION	117#

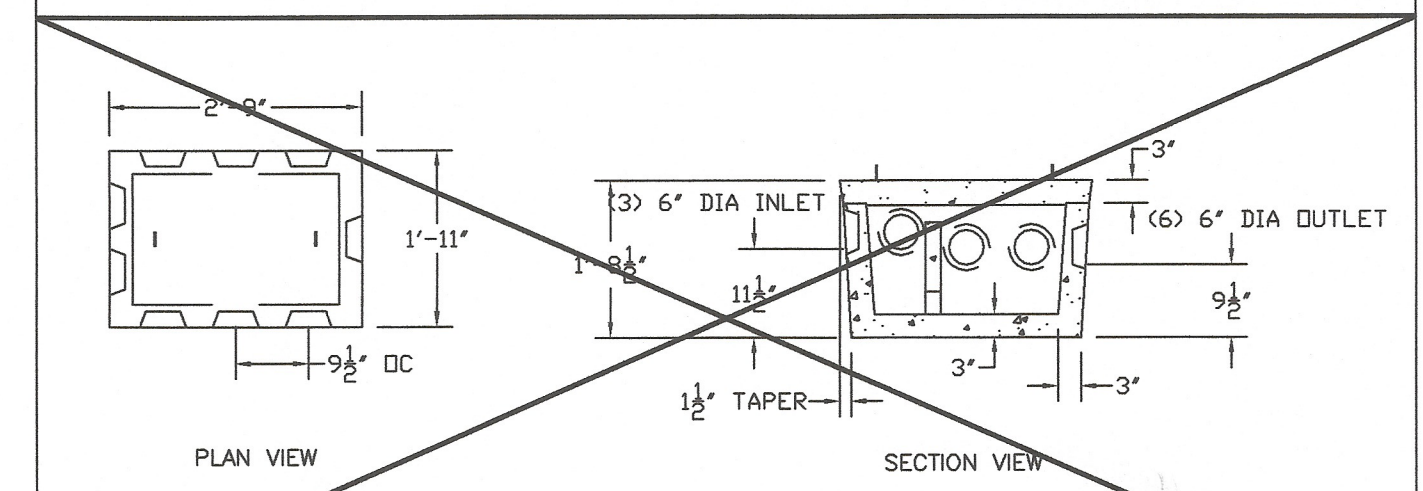

Item No.	Description	Weight
B-6DBB	W/COVER	734#
B-6DBBC	COVER ONLY	704#

- NOTES:**
- CONCRETE: 4,000 PSI MINIMUM AFTER 28 DAYS.
 - DESIGN CONFORMS WITH 310 CMR 15.00, DEP TITLE 5 REGS, FOR DISTRIBUTION BOXES.

E.F. SHEA
 NEW ENGLAND
 CONCRETE PRODUCTS, INC.
 DISTRIBUTION BOX
 6 OUTLET

WILMINGTON, MA (978) 658-2645 -- AMESBURY, MA (978) 388-1509
 NOTTINGHAM, NH (603) 942-5668

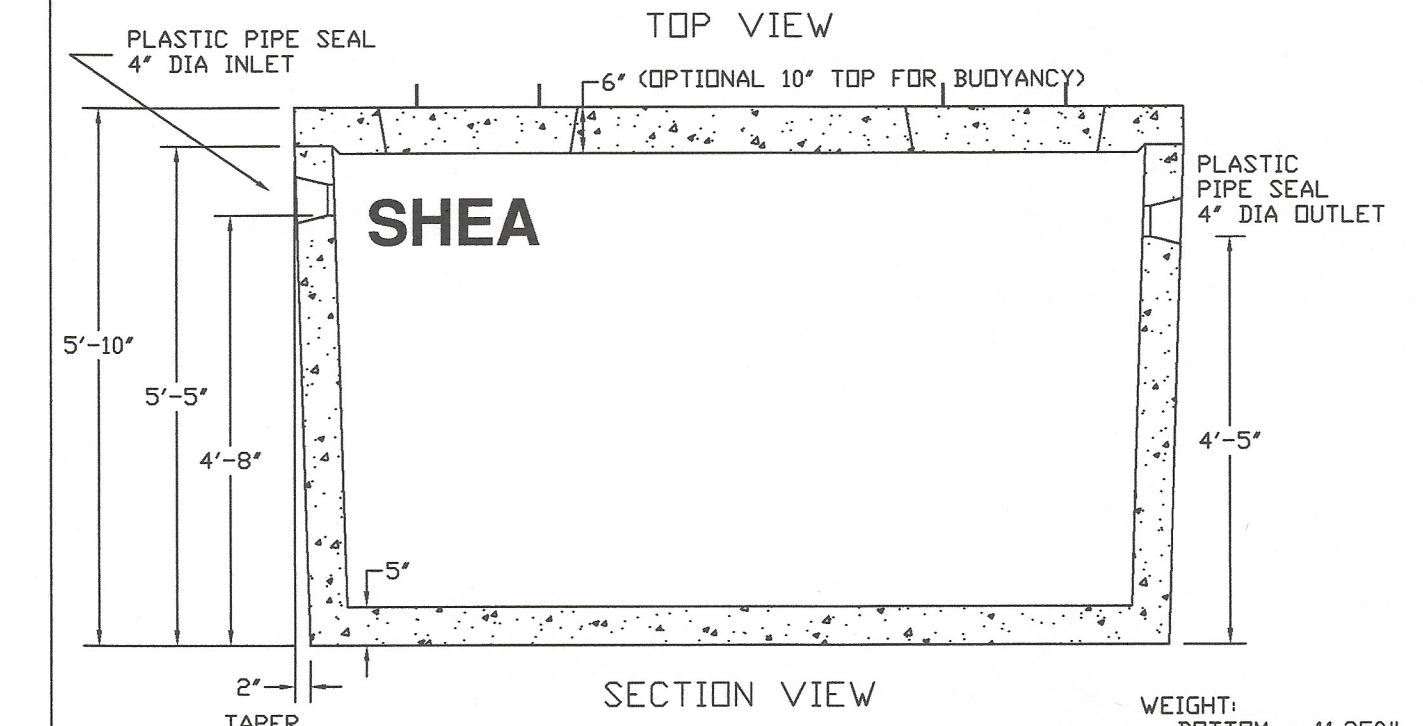
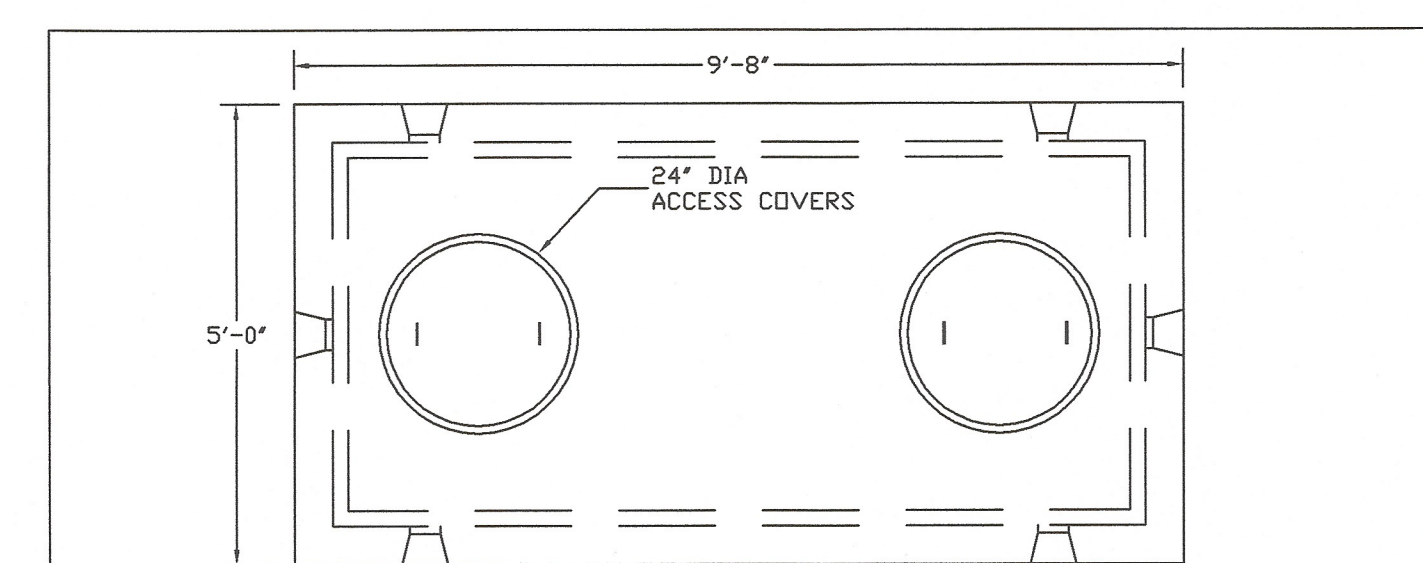

Item No.	Description	Weight
PC1000	STANDARD (6" TOP)	11,250#
PC1000H	H-20 (6" TOP)	5,960#
PC1000HT10	H-20 (10" TOP)	3,575#

- NOTES:**
- CONCRETE: 4,000 PSI MINIMUM AFTER 28 DAYS.
 - DESIGN CONFORMS WITH 310 CMR 15.00, DEP TITLE 5 REGS, FOR PUMP CHAMBERS.
 - ALL REINFORCEMENT PER ASTM C1227-93.
 - ALSO AVAILABLE IN H-20 LOADING.
 - JOINT SEALED WITH BUTYL RESIN.
 - PUMPS AND ACCESSORIES OPTIONAL.

E.F. SHEA
 NEW ENGLAND
 CONCRETE PRODUCTS, INC.
 PUMP CHAMBER MONOLITHIC
 1000 GALLON

WILMINGTON, MA (978) 658-2645 -- AMESBURY, MA (978) 388-1509
 NOTTINGHAM, NH (603) 942-5668

REVISIONS:

DRAWN: RMG
 CHECKED: BJF
 SCALE: AS NOTED
 DATE: 06-15-2021
 DWG No. V:\CON\NEWV\210614

MASSACHUSETTS
 BRIAN J. FARNER
 LAND REGISTRY
 6/15/21

SEAL
 ROBERT M. GRASSO
 C. 02125
 LAND REGISTRY
 6/15/21

OWNER: CHRISTINE HOXHA
 TAX MAP 31 BLK 01 LOT 14
 LOCUS DEED: BK 37623 PG 36

LOCATION: 57 STONECLEAVE ROAD
 BOXFORD, MA 01921

Engineering Land Services, LLC
 P.O. BOX 41
 WEST NEWBURY, MA 01985
 TEL: 978-815-6744 & FAX: 978-462-6800
 EMAIL: MASSPLSRG@AOL.COM

**SANITARY DISPOSAL
 SYSTEM UPGRADE PLAN
 (REPAIR)**