

I HEREBY CERTIFY THAT IN OCTOBER 1997, I HAVE PASSED THE EXAMINATION APPROVED BY THE D.E.P. AND THAT THE ABOVE ANALYSIS WAS PERFORMED BY ME CONSISTENT WITH THE REQUIRED TRAINING, EXPERTISE AND EXPERIENCE DESCRIBED IN CMR 15.017.

Rob M. Grasso
 6-15-21

ROBERT M. GRASSO, P.L.S., SE#933 DATE
 USDA - S.C.S. SOIL TYPES
 THE ENTIRE SITE IS MAPPED AS:
 MoC - MONTAUK

DIMENSION TABLE:
 PIPE SEPARATION = 1.42'
 LINE LENGTH = 60.0'
 PIPE CENTER O.C. = 2.42'
 BED WIDTH = 20.0'
 BED LENGTH = 62.0'

SOIL LOG		SOIL LOG	
HEALTH AGENT <u>ROBERT LONGO</u> SOIL EVALUATOR <u>ROBERT GRASSO</u> DATE: <u>05-17-2021</u>		HEALTH AGENT <u>ROBERT LONGO</u> SOIL EVALUATOR <u>ROBERT GRASSO</u> DATE: <u>05-17-2021</u>	
TEST PIT # <u>01</u>	ELEV = 100.5'	TEST PIT # <u>02</u>	ELEV = 100.2'
38" FILL		30" FILL	
47" AB - F.S.L. 10YR 2/2		37" AB - F.S.L. 10YR 2/2	
56" BW - F.S.L. 10YR 4/6		47" BW - F.S.L. 10YR 4/6	
C - SLOAM 2.5Y 5/3		C - SLOAM 2.5Y 5/3	
109" WATER TABLE	.86" OBSERVED	108" WATER TABLE	.86" OBSERVED
	.56" ESTIMATED 95.9'		.47" ESTIMATED 96.3'

PERCOLATION TESTS
 SOIL ANALYSIS CONDUCTED BY
 PENN STATE EXTENSION
 SOIL LABORATORY
 DEEP HOLE #1
 65.3% SAND, 28.5% SILT, 6.2% CLAY
 (CL II SANDY LOAM)
 DEEP HOLE #2
 46.2% SAND, 45.8% SILT, 8.0% CLAY
 (CL II LOAM)

INVERT TABLE	
AT BLDG	101.0' ± EXIST
TANK IN	99.00'
TANK OUT	98.75'
PUMP IN	98.70'
PUMP OUT	98.45'
D-BOX IN	103.05'
D-BOX OUT	102.88'
BEG 4" PIPE	102.68'
END 4" PIPE	102.68'
TOP 12" PIPE	103.10'
12" PIPE INV	102.10'
BOTTOM BED	101.60'
GROUNDWATER	97.6' ADJ @ EL 101.5'

DESIGN CRITERIA (30 MIN/INCH)
 USE 0.33 GPD/S.F. - CL II (LOAM)
 NUMBER OF BEDROOMS: 4 DESIGN FLOW: 165 GALLONS PER BEDROOM
 TOTAL NO. ROOMS: 9
 TOTAL DAILY FLOW: 660 GPD. LEACHING AREA: 2000 S.F.
 MIN. 420' L.F. OF ENVIRO PIPE REQ'D. 1200 S.F. - MIN. PRESBY BED SIZE
 MIN. 1.75' O.C. PIPE SPACING

NO GARBAGE GRINDER TO BE USED.
 ACTUAL LEACHING AREA PROVIDED: 1240 S.F.
 CALCULATED DAILY FLOW: SAND BED SIZE: 20.0'W x 62.0'L = 1240 S.F.

480' L.F. x 1.57 GAL/L.F. AT 30 MPI = 753 GPD >= 660 GPD REQ'D.
 8 LINES (60.0' - 2.42' O.C. + 1.0 SAND AROUND)

NOTES:
 REMOVE ALL UNSUITABLE SOIL MATERIAL FOR A MINIMUM OF 5' ALL AROUND LEACH AREA AND (60') BELOW EXISTING GRADE, AND REPLACE WITH CLEAN FILL MEETING TITLE 5, 310 CMR 15.255(3).
 INSTALL FLOW LEVELERS AT DISTRIBUTION BOX OUTLETS. (GRAVITY ONLY)
 DIMENSIONS, DETAILS, AND SHAPE OF SEPTIC TANK AND DISTRIBUTION BOX WILL VARY SLIGHTLY WITH MANUFACTURER.
 ALL UNITS SHALL CONFORM WITH THE REGULATIONS OF TITLE 5 OF THE MASSACHUSETTS ENVIRONMENTAL CODE, AND WITH ALL APPLICABLE LOCAL BOARD OF HEALTH REQUIREMENTS.
 PRESBY ENVIRO-SEPTIC SYSTEM CANNOT BE USED WITH A PRESSURE DISTRIBUTION SYSTEM.

THIS SYSTEM REQUIRES 2 CELLS OF ENVIRO-SEPTIC PIPES. EACH CELL HAS 4 DIST. LINES 60.0' IN LENGTH.

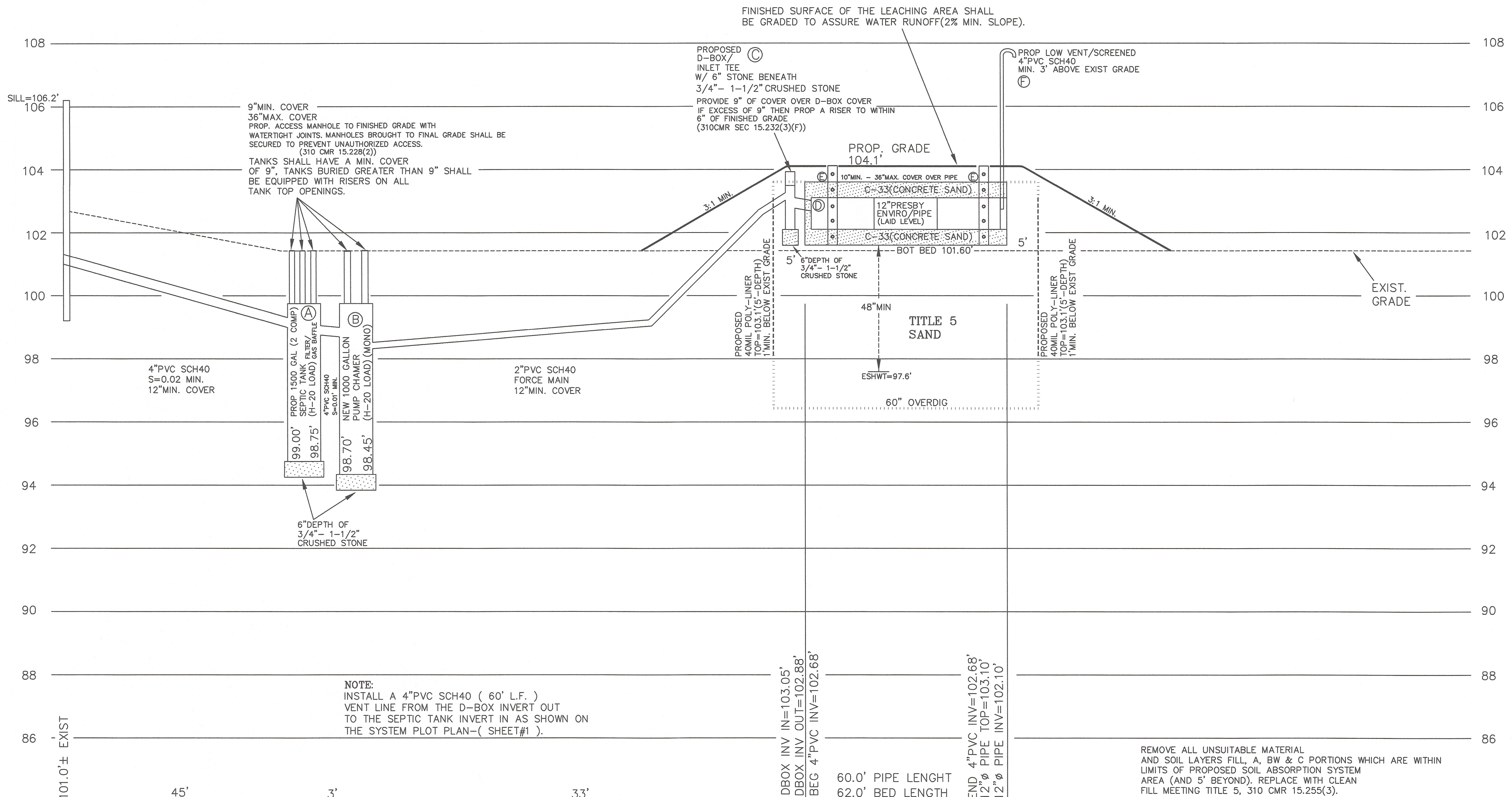
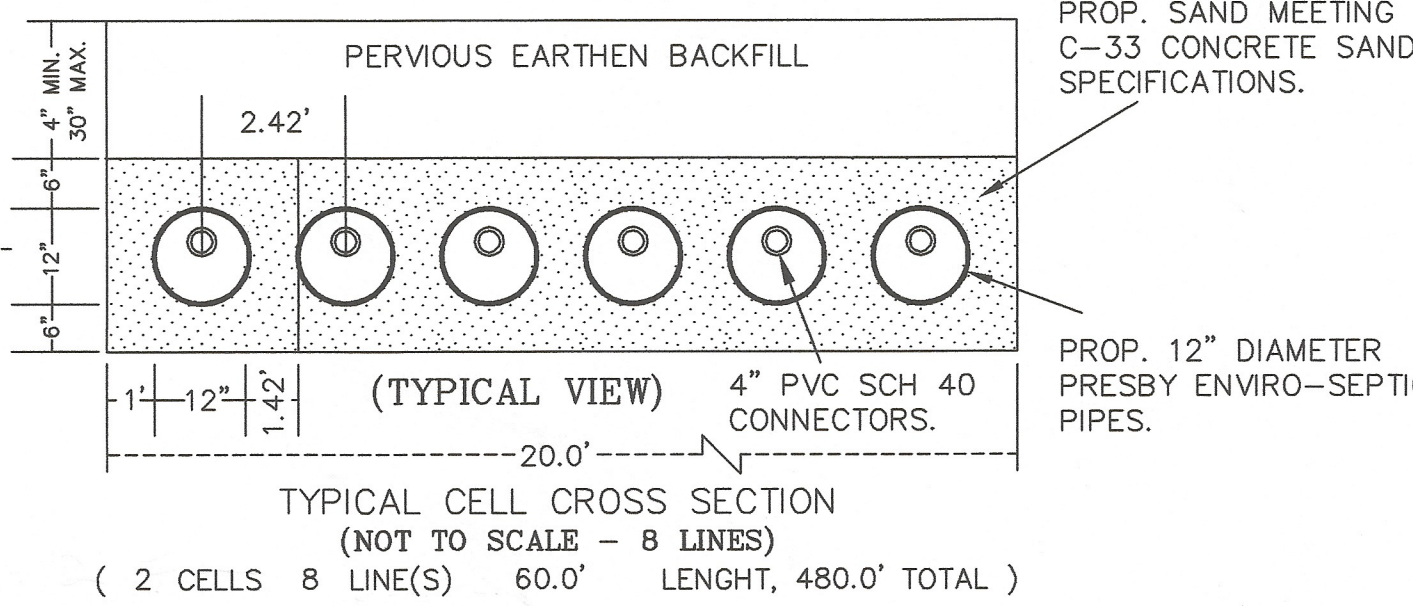

SYSTEM PROFILE
 SCALE: VER. 1" = 2'

NOTE: SET TANK INVERTS TO MEET EXISTING BUILDING SEWER INVERT.

NOTE: ALL OTHER GREYWATER PIPES SERVICING WASHERS, SINKS, ETC SHALL BE CONNECTED TO THE SEPTIC TANK.

REVISIONS:

NO.	DATE	DESCRIPTION

DRAWN: RMG
 CHECKED: BJF
 SCALE: AS NOTED
 DATE: 06-15-2021
 DWG No.

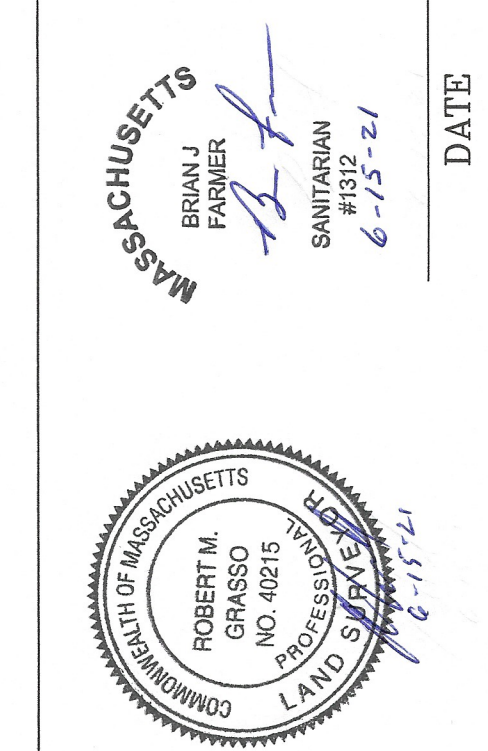

OWNER: CHRISTINE HOXHA
 TAX MAP 31 BLK 01 LOT 14
 LOCUS DEED: BK 37623 PG 36
 LOCATION: 57 STONECLEFT ROAD
 BOXFORD, MA 01921

Engineering Land Services, LLC
 P.O. BOX 41
 WEST NEWBURY, MA 01985
 TEL: 978-815-6744 & FAX: 978-462-6800
 EMAIL: MASSPLSRG@AOL.COM

SANITARY DISPOSAL SYSTEM UPGRADE PLAN (REPAIR)