

**EROSION AND SEDIMENTATION CONTROL NOTES**

1. THE EROSION AND SEDIMENTATION CONTROL BEST MANAGEMENT PRACTICES PROVIDED REPRESENT THE MINIMUM MEASURES TO BE EMPLOYED DURING EACH PHASE OF CONSTRUCTION. THE CONTRACTOR IS RESPONSIBLE FOR INSTALLING ADDITIONAL BEST MANAGEMENT PRACTICES AS NECESSARY TO MEET FIELD CONDITIONS AT THE TIME OF AND DURING ALL PHASES OF CONSTRUCTION.
2. WHERE LINEAR SEDIMENTATION CONTROL MEASURES ARE INDICATED ON THE PLAN THEY SHALL CONSIST OF A SINGLE ROW ALONG WITH APPROVED SEDIMENT FENCE ON THE WETLAND SIDE OF THE COMPOST FILTER SOCKS AND ORANGE CONSTRUCTION FENCE OF THE UPLAND SIDE OF THE COMPOST FILTER SOCKS.
3. CONSTRUCTION LAYDOWN AREA SHALL INCLUDE MATERIAL STOCKPILING, VEHICLE/EQUIPMENT STORAGE, PRODUCT STORAGE, WASTE STORAGE, PORTABLE SANITARY UNIT AND FUELING AND MAINTENANCE OF EQUIPMENTS AND VEHICLES. CONCRETE WASHOUT AREA TO INCLUDE WASHING OF APPLICATORS, CONTAINERS, VEHICLES AND EQUIPMENT.
4. REFER TO SECTION 4 OF THE STORMWATER POLLUTION PREVENTION PLAN (SWPPP) FOR A LIBRARY OF EROSION AND SEDIMENT CONTROLS THAT ARE TO BE IMPLEMENTED AT THE PROJECT SITE DURING CONSTRUCTION, AS NEEDED. INCLUDED IN THIS SECTION ARE DESCRIPTIONS, MAINTENANCE EQUIPMENTS AND DESIGN SPECIFICATIONS FOR THE EROSION AND SEDIMENT CONTROLS.
5. REFER TO SECTION 5 OF THE SWPPP FOR POLLUTION PREVENTION STANDARDS THAT ARE TO BE IMPLEMENTED AT THE PROJECT SITE DURING CONSTRUCTION, AS NEEDED. INCLUDED IN THIS SECTION ARE DESCRIPTIONS, MAINTENANCE REQUIREMENTS AND DESIGN SPECIFICATIONS FOR THE POLLUTION PREVENTION PRACTICES.
6. REFER TO SECTION 6 OF THE SWPPP FOR INSPECTION AND CORRECTIVE ACTION PROCEDURES THAT ARE TO BE IMPLEMENTED AT THE PROJECT SITE DURING CONSTRUCTION.

**LEGEND**

- EXISTING CONTOUR
- EXISTING TREE
- ZONING SETBACK
- TEMPORARY SEDIMENTATION BASIN
- TEMPORARY CONVEYANCE CHANNEL

**NOTES**

1. EXISTING CONDITIONS INFORMATION IS BASED ON SURVEY FROM "ASB DESIGN GROUP LLC" FOR PROJECT TITLED "146 GEORGETOWN ROAD - SEPTIC SYSTEM". THIS DESIGNED SEPTIC SYSTEM HAD BEEN APPROVED BY THE BOXFORD CONSERVATION COMMISSION.
2. ALL AREAS DISTURBED BY PROPOSED WORK SHALL BE LOAMED AND SEEDED PER DETAIL "STABILIZATION MULCHING AND SEEDING DETAIL"
3. PROJECT LOCATED ON FEMA FLOOD INSURANCE RATE MAP (FIRM), MAP NUMBER 2509C0261F, AS ZONE A. ZONE AH FOR BASE FLOOD ELEVATION IS GIVEN BETWEEN 1-3 FT IN AREAS OF PONDING. GIVEN ZONE AH IS AT HIGHER RISK THAN ZONE A THEREFORE BASE FLOOD ELEVATION ESTIMATED AT 114' USING THE MAXIMUM DEPTH OF 3'.

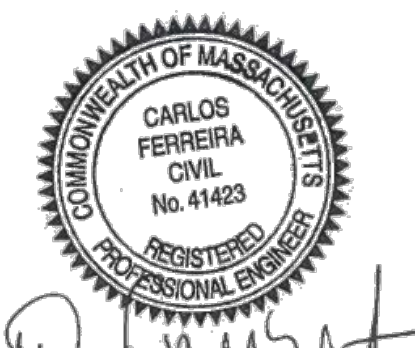
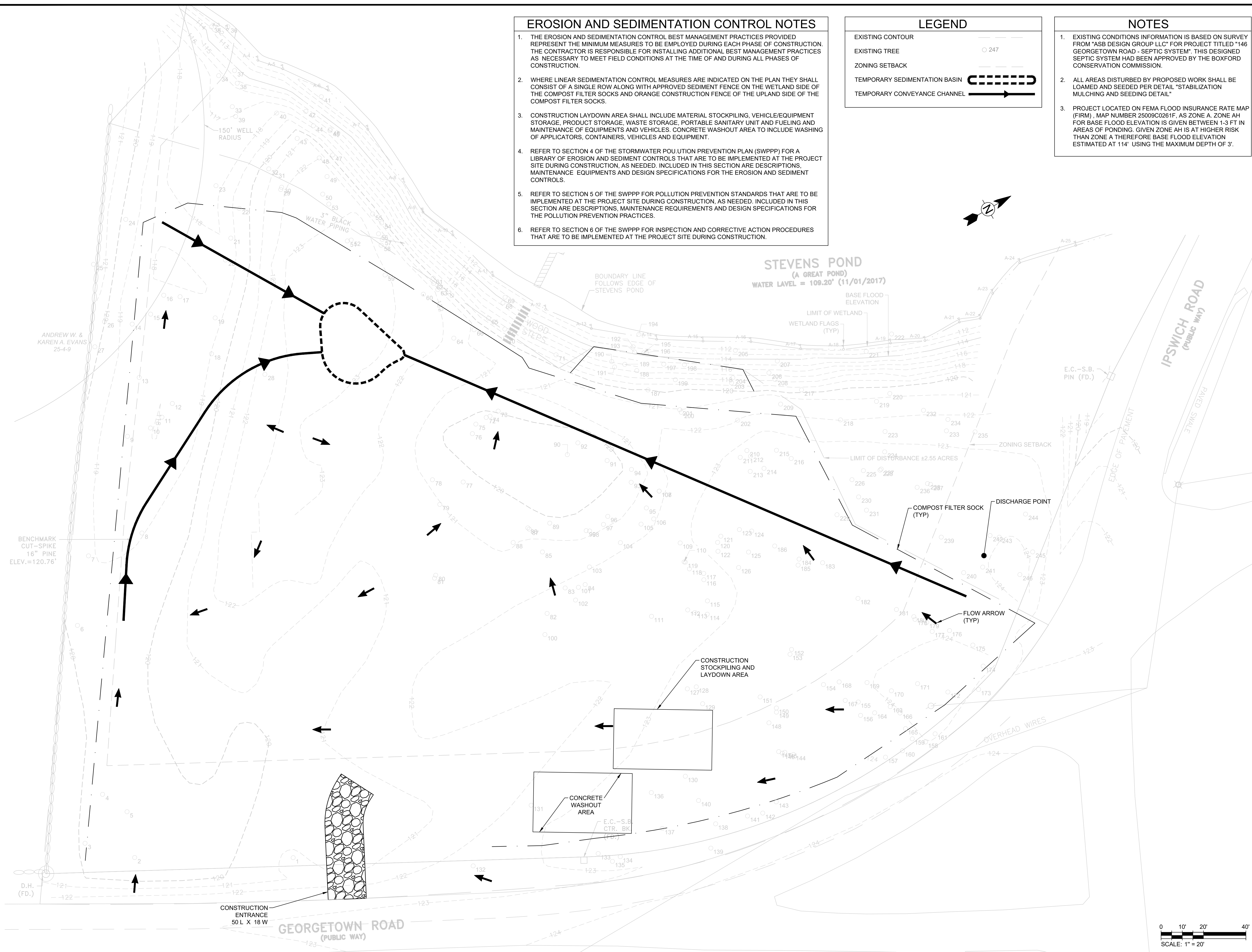

*Carlos Ferrera*

No.	Date	Description
Revisions		

Prepared for:  
**CLAUDIO SENA**  
 146 GEORGETOWN ROAD  
 BOXFORD, MA, 01921

Property of:  
**142 FISHER STREET LLC**  
 142 FISHER STREET  
 WESTBOROUGH, MA 01581

Prepared By:

**ENGINEERING & DESIGNS**  
 Structural Engineering / Building Design  
 Civil Engineering / Management Services  
 CARLOS FERRERA PROFESSIONAL ENGINEER  
 PHONE: 508-331-7261 SITE: WWW.MF-ENG.COM  
 EMAIL: CARLOS.FERRERA@MF-ENG.COM

Project Title  
**SENA RESIDENCE**

Sheet Title  
**EROSION AND SEDIMENT CONTROL SITE MAP**

SCALE	1" = 20'
DRAWN	MAD
CHECKED	CEF
FILE NAME	146 GEORGETOWN
PROJECT	146 GEORGETOWN RD
ISSUE DATE	
JOB NO.	146-0521